

EXHIBIT 1

Chris Larson

From: Mike Kruse
Sent: Wednesday, January 6, 2021 3:25 PM
To: Chris Larson
Subject: FW: SDDOT Project - SD50 Vermillion
Attachments: 04YU_SectionL(shared with City of Vermillion and Clay Union CO-OP).pdf

Mike Kruse

Operations Manager
Clay-Union Electric Corporation
605-624-2673 or 1-800-696-2832
Cell # 605-202-1061



Your Touchstone Energy® Cooperative

Clay-Union Electric is an Equal Opportunity Provider and Employer.

From: Pyle, Timothy <Timothy.Pyle@state.sd.us>
Sent: Wednesday, July 1, 2020 3:26 PM
To: Shane Griese <shane@cityofvermillion.com>; Mike Kruse <mkruse@clayunionelectric.coop>
Cc: VanDeWiele, Kelly <Kelly.VanDeWiele@state.sd.us>
Subject: SDDOT Project - SD50 Vermillion

Shane/Mike

Attached is a PDF of the lighting section of plans, I wanted to get these to you guys to take a look at because of the electrical territories with a varying boundaries. I have highlighted the poles and conduit runs. There are some conduit runs that will have both City and Clay Union wires running in the same conduit. Pink is City of Vermillion, Yellow would be Clay Union.

Poles being powered from Clay Union Co-Op (Yellow) Includes: L1, L2, L4, L6, L8, L14-L19, L40, L42, L47, L49

Poles being powered from City of Vermillion power (Pink) includes: L3, L5, L7, L9, L10 – L13, L20 – L39, L41, L43 – L46, L48, L50 – L57

There are 6 poles (EL4- EL9) – 2 at each of the following intersections N. Plum, N. University, and N. Dakota that are being called out as remove and dispose of. Once this project gets into construction the contractor will need to disconnect these from their power source(s). I have exhaust all avenues looking for old plans for these poles to find out where they are powered from. I have added a plan note to coordinate with the local power companies to disconnect them from existing power. Yes, there are underground utilities shown on the plans but, I also have worked in the field long enough to know not to trust these to be 100% accurate.

EXHIBIT 1

Hopefully I was able to keep everything straight and by getting your eyes on these before construction we can have smooth project. Any question or comments please feel free to contact me.

Tim Pyle
Engineer II
Road Design – Traffic
South Dakota Department of Transportation
(605) 209 - 4883

EXHIBIT 1

SECTION L: LIGHTING PLANS

STATE OF SOUTH DAKOTA	PROJECT	SHEET	TOTAL SHEETS
	NH 0050(117)407	L1	L37

Plotting Date: 06/25/2020

INDEX OF SHEETS

- L1 General Layout With Index
- L2-L5 Estimate With General Notes & Tables
- L6-L30 Conduit Layouts
- L31-L33 Wiring Diagrams
- L34-L37 Standard Plates

BEGIN NH 0050(117)407
Station a 0+00

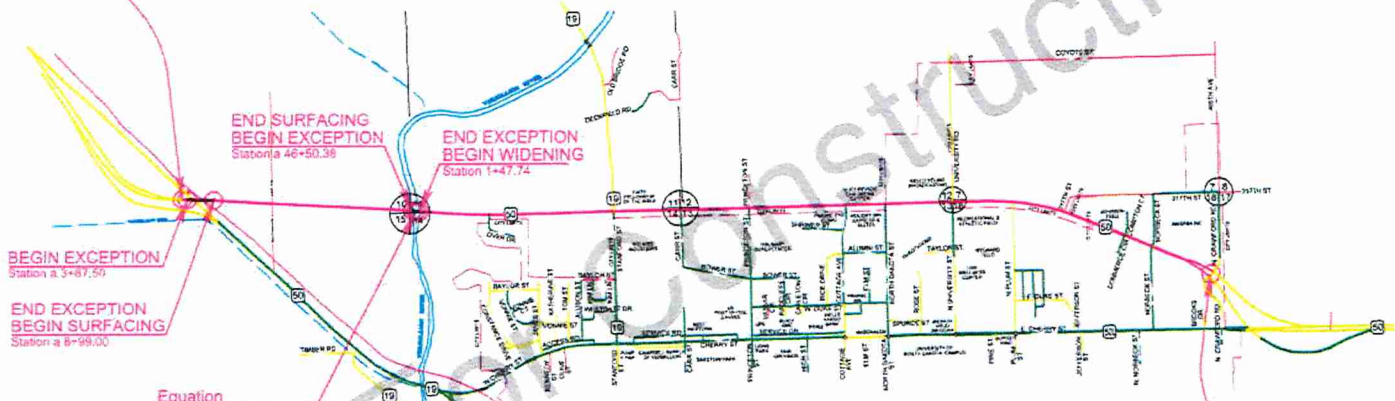

VERMILLION

END NH 0050(117)407
Station 156+51.67



Not For Construction

D:\Projects\117\117_0050\117_0050.dwg

File: U:\117_0050\117_0050.dwg

EXHIBIT 1

STATE OF SOUTH DAKOTA	PROJECT	SHEET	TOTAL SHEETS
	NH 0050(117)407	L2	L37

Plotting Date: 06/25/2020

SECTION L ESTIMATE OF QUANTITIES

TABLE OF FOOTING DATA

Site Designation	Footing Diameter	* Footing Depth	**Spiral Diameter	**Spiral Length	Vertical Reinforcement
L1 - L54	2' - 0"	8' - 0"	1' - 8"	54' - 9"	8-#7 x 7' - 6"
L55 - L57	2' - 0"	9' - 0"	1' - 8"	60' - 0"	8-#7 x 8' - 6"

- * Footing depth will be below ground level.
- ** The size of all spirals will be #3.

LUMINAIRES

The lighting design used the following parameters and provides 0.8 and greater average maintained foot-candles and uniformity ratios of 3:1 (average maintained to minimum maintained foot-candles) and 6:1 (maximum to minimum maintained foot candles):

Setback:	0 Ft.
Lamp Loss Factor (LLF):	0.8
Width of Lighted Area:	60 Ft.
Spacing:	525 Ft.
Configuration:	Staggered
Mounting Height:	50 Ft.
Arm Length	8 Ft.
Lamp:	LED

The following LED luminaires meet the requirements for this design:

a.) Leotek Electronics:

GC2-96G-MV-NW-3R-GY-975
Test No. 1216713 LED, Medium, Type III

b.) American Electric Lighting:

ATB2_80BLED10_10_XXXXX_R3
Test No. LTL25370P39, LED, medium, Type III

Contractor will remove High Pressure Sodium, (HPS) Luminaires from EL 1 and EL3 and replace with new "Roadway Luminaire, LED with Photoelectric Cell". All costs for labor and material to change the HPS Luminaires to LED Luminaires will be incidental to the contract unit price per each for "Roadway Luminaires, LED with Photoelectric Cell".

WIRE SPLICING FOR LIGHTING

All wire splices for lighting will be made using TE Connectivity GTAP connectors, NSI Industries Polaris Blue connectors, or an approved equal.

MISCELLANEOUS, ELECTRICAL

The Contractor will coordinate with local electrical utility companies to field verify, locate, and disconnect existing power supply for EL4 - EL9 prior to removing and disposing poles. The existing lighting system wiring between EL4 - EL9 connecting to existing power supply will either be completely removed or abandoned with current electrical best management practices. All costs for labor and material to disconnect and remove or abandoned the existing lighting system wiring will be incidental to the contract lump sum price for "Miscellaneous, Electrical".

SUPPLYING AS BUILT PLANS

If the traffic signal systems or roadway lighting systems are constructed differently than what is stated in the plans, the Contractor will supply as built plans to the Engineer and a copy will be sent to the Traffic Design Engineer. The as built plans may include conduit layouts, wiring diagrams, or other drawings depicting the changes from the original plans.

SHOP DRAWING AND CATALOG CUTS SUBMITTALS

The Contractor will submit shop drawings and catalog cuts in accordance with Section 985 of the Specifications.

Adobe PDF submittals will be sent to the following email addresses:

Timothy.Pvie@state.sd.us
Kelly.VanDeWele@state.sd.us

REMOVE LUMINAIRE POLE FOOTING

The footings of existing luminaire poles EL4 - EL9 will be removed by the Contractor to a minimum of 2' below the ground surface. Restoration of the disturbed area will be to the satisfaction of the Engineer.

All costs for removing the footings of the existing luminaire poles will be incidental to the contract unit price per each for "Remove Luminaire Pole Footing".

EXHIBIT 1

CONDUIT LAYOUT SD HWY 50

STATE OF SOUTH DAKOTA	PROJECT NH 0050(117)407	SHEET L6	TOTAL SHEETS L37
Plotting Date: 06/25/2020			

SCALE
1" = 40'



SALVAGE			
KEY	Remove	ITEM	EST QUANT UNIT
◆	Remove	Salvage Luminaire Pole (EL4-EL9)	EACH

ESTIMATE OF QUANTITIES			
KEY	ITEM	EST QUANT	UNIT
◆	Remove Luminaire Pole Footing (EL4-EL9)		EACH
—	Breakaway Base Luminaire Pole w/8' Arm 50' Mounting Height (L1-L54)		EACH
—	Breakaway Base Luminaire Pole w/Twin 8' Arm 50' Mounting Height (L55-L57)		EACH
•	Roadway Luminaire, LED with P.E. (EL1, EL3, L1-L57)		EACH
○	2' Diameter Footing (L1-L57)		FT
□	Type 1 Electrical Junction Box (JL0-JL33)		EACH
▲	Electrical Service Cabinet		EACH
⊗	Galvanized Steel Utility Pole Not a Bid Item		EACH
⊙	Meter Socket Not a Bid Item		EACH
⊗	2" Rigid Conduit, Schedule 40		FT
⊗	2" Rigid Conduit, Schedule 80		FT
⊗	1/C #3 AWG Copper Wire		FT
⊗	1/C #6 AWG Copper Wire		FT
⊗	2/C #10 AWG Copper Pole & Bracket Cable		FT

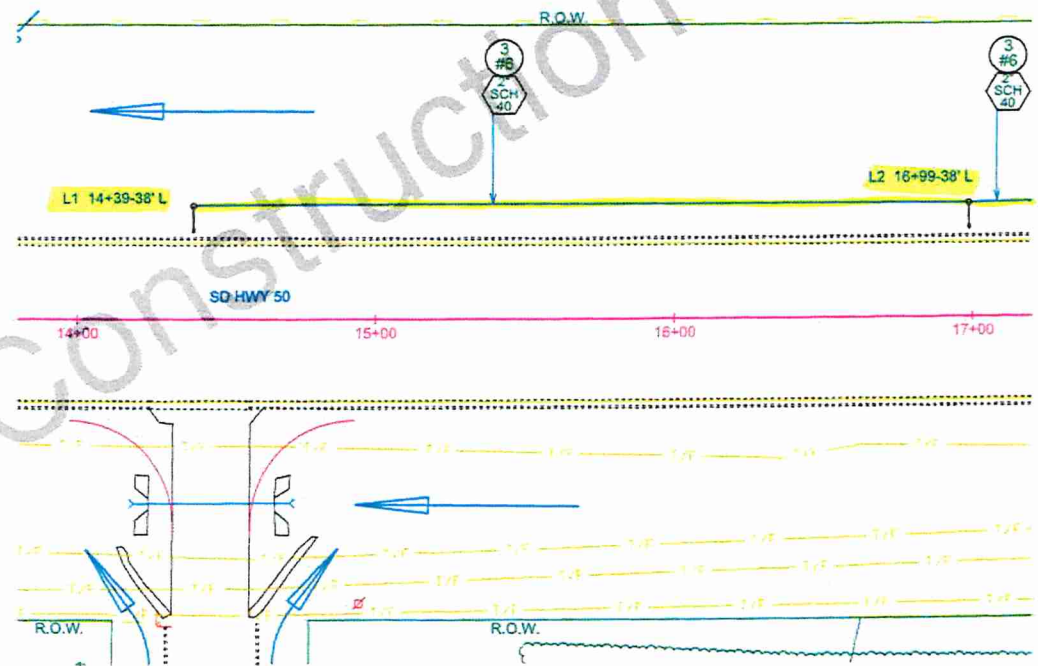
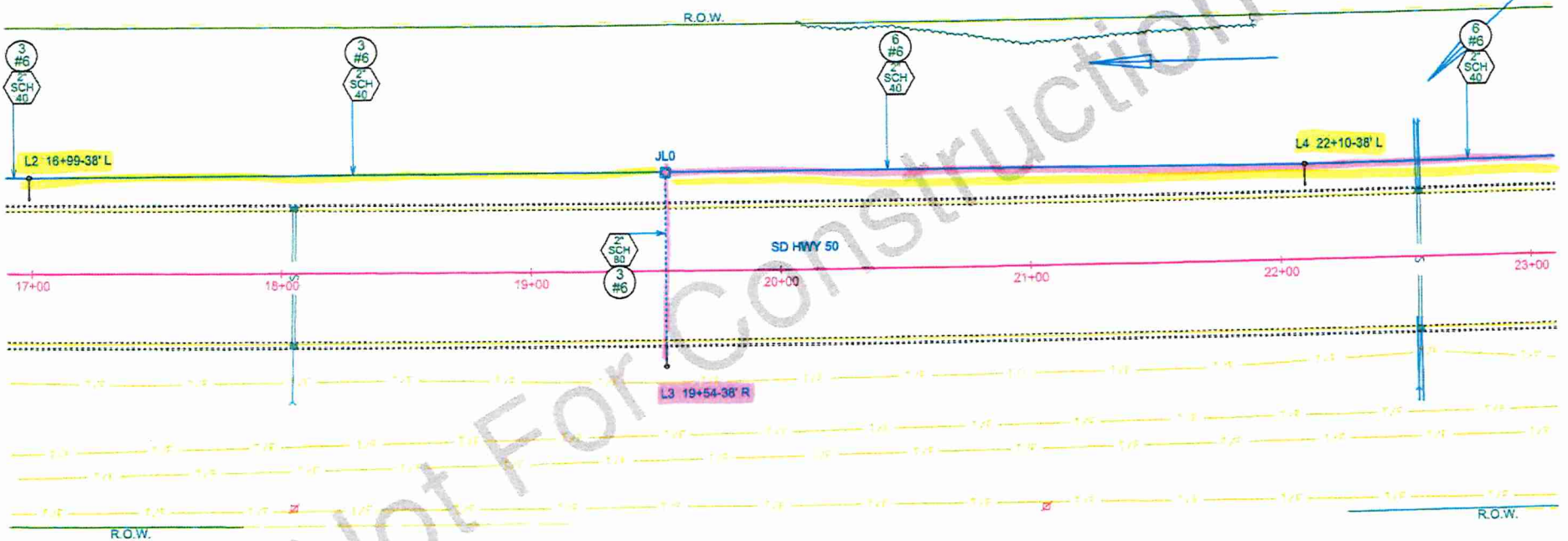

EXHIBIT 1

CONDUIT LAYOUT SD HWY 50

STATE OF SOUTH DAKOTA	PROJECT	SHEET	TOTAL SHEETS
	NH 0050(117)407	L7	L37
Plotting Date: 06/29/2020			

SCALE
1" = 40'



1.40

Sheet 0017

06/23/2020

06/23/2020

File: \\sdc\p1\17\170407\170407.dwg

EXHIBIT 1

CONDUIT LAYOUT SD HWY 50

STATE OF SOUTH DAKOTA	PROJECT	SHEET	TOTAL SHEETS
	NH 0050(117)407	L8	L37

Plotting Date: 06/29/2020

SCALE
1" = 40'

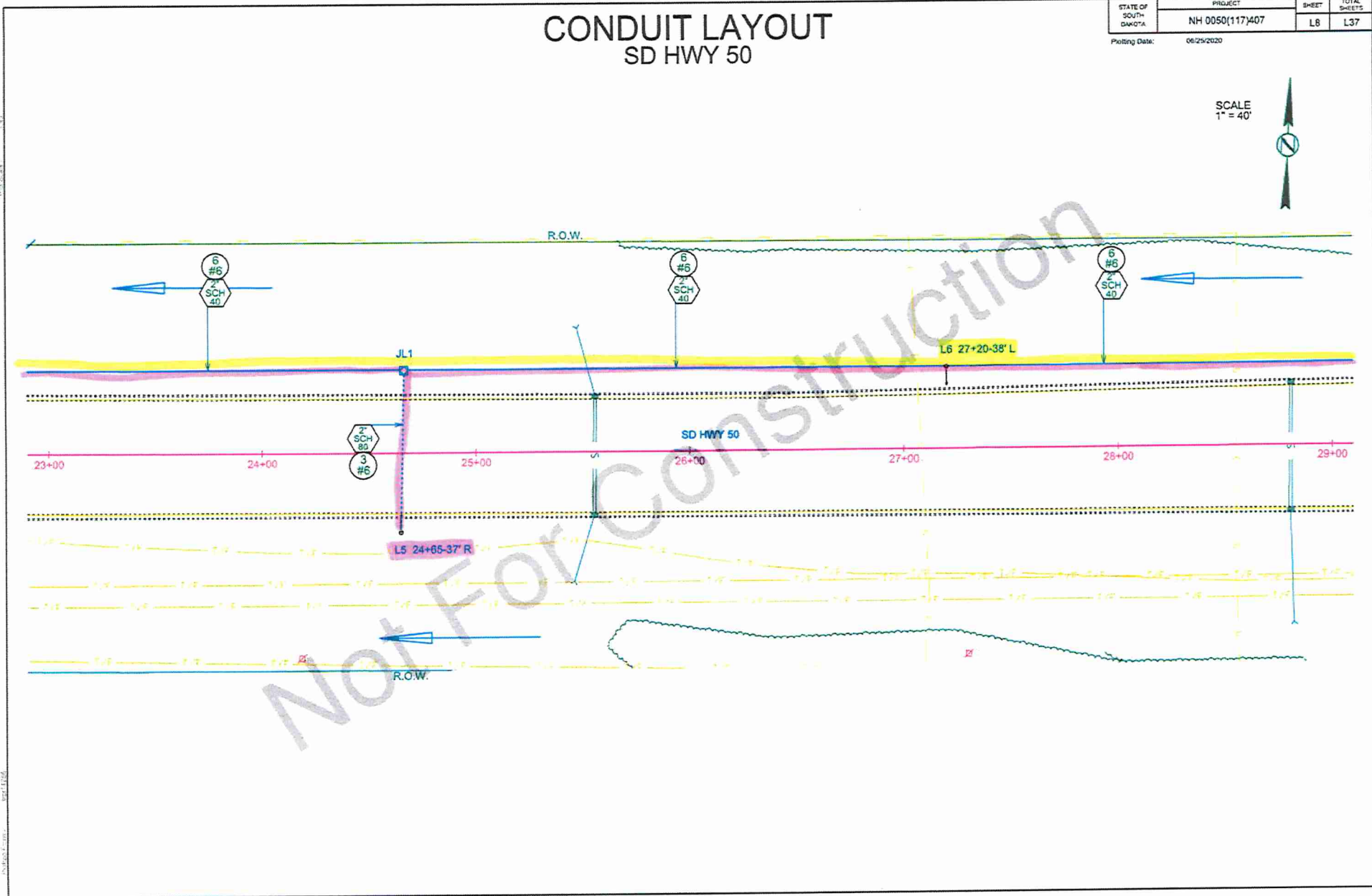

06/29/2020 11:41

06/29/2020 11:41

06/29/2020 11:41

EXHIBIT 1

CONDUIT LAYOUT SD HWY 50

STATE OF SOUTH DAKOTA	PROJECT	SHEET	TOTAL SHEETS
	NH 0050(117)407	L9	L37
Plotting Date: 06/25/2020			

SCALE
1" = 40'

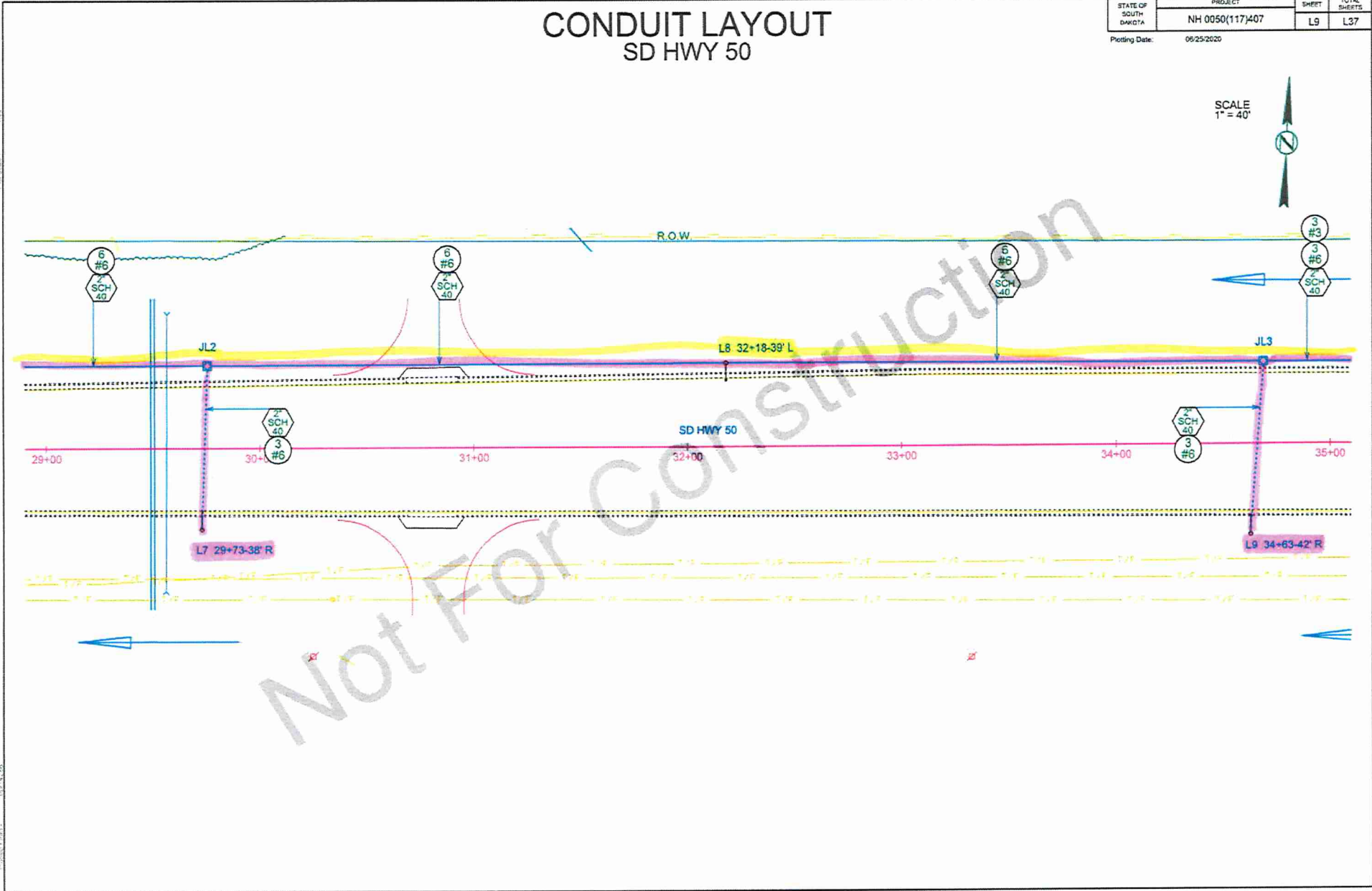

Plot Scale: 1" = 40'

Plot Date: 06/25/2020

U:\projects\117\117407.dwg

EXHIBIT 1

CONDUIT LAYOUT SD HWY 50

STATE OF SOUTH DAKOTA	PROJECT	SHEET	TOTAL SHEETS
	NH 0050(117)407	L10	L37
Plotting Date:		06/25/2020	

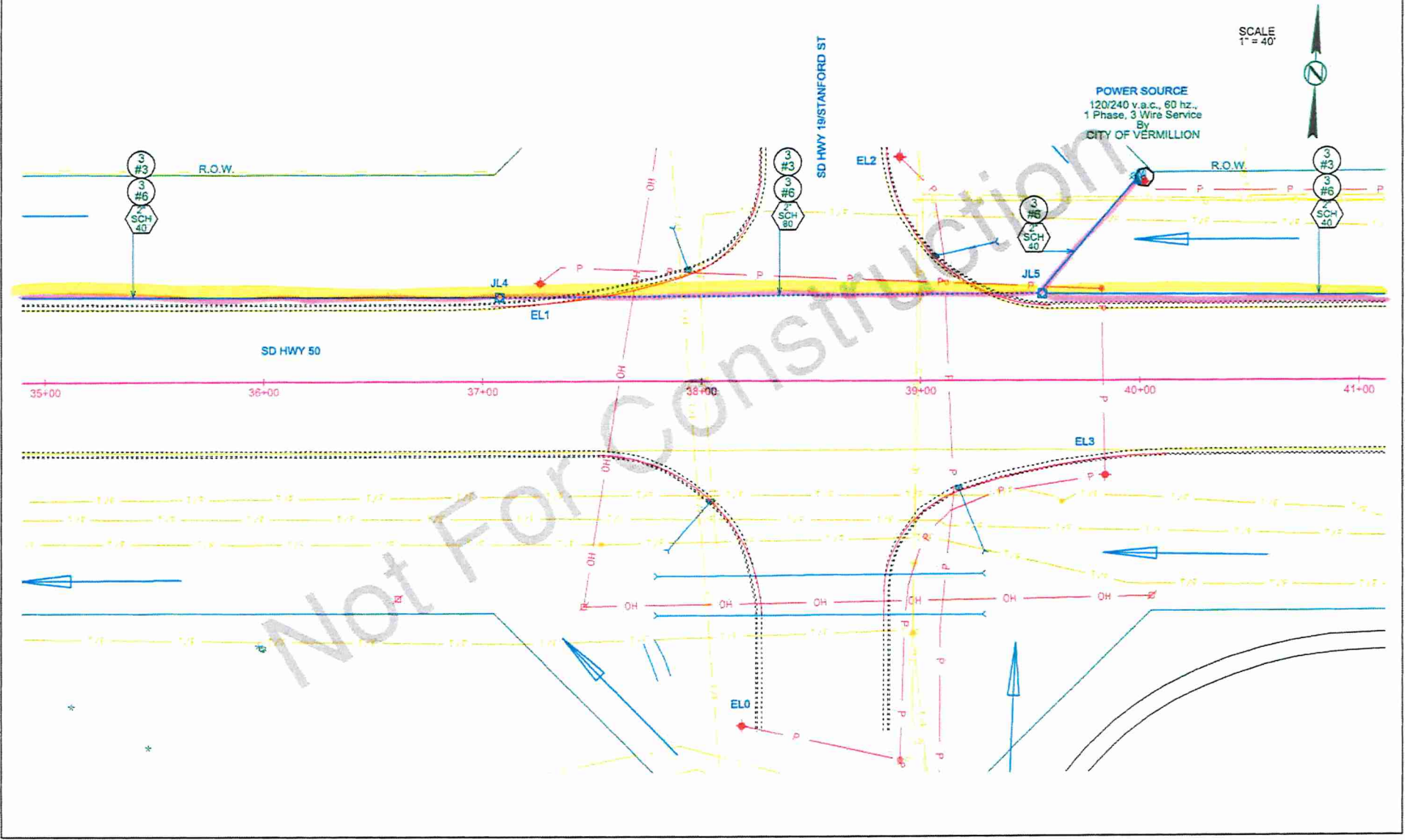

Vertical Datum: 1985
Horizontal Datum: NAD 83

File: S:\NH0050\117\407.dwg

EXHIBIT 1

CONDUIT LAYOUT SD HWY 50

STATE OF SOUTH DAKOTA	PROJECT NH 0050(117)407	SHEET L11	TOTAL SHEETS L37
Plotting Date: 06/25/2020			

SCALE
1" = 40'

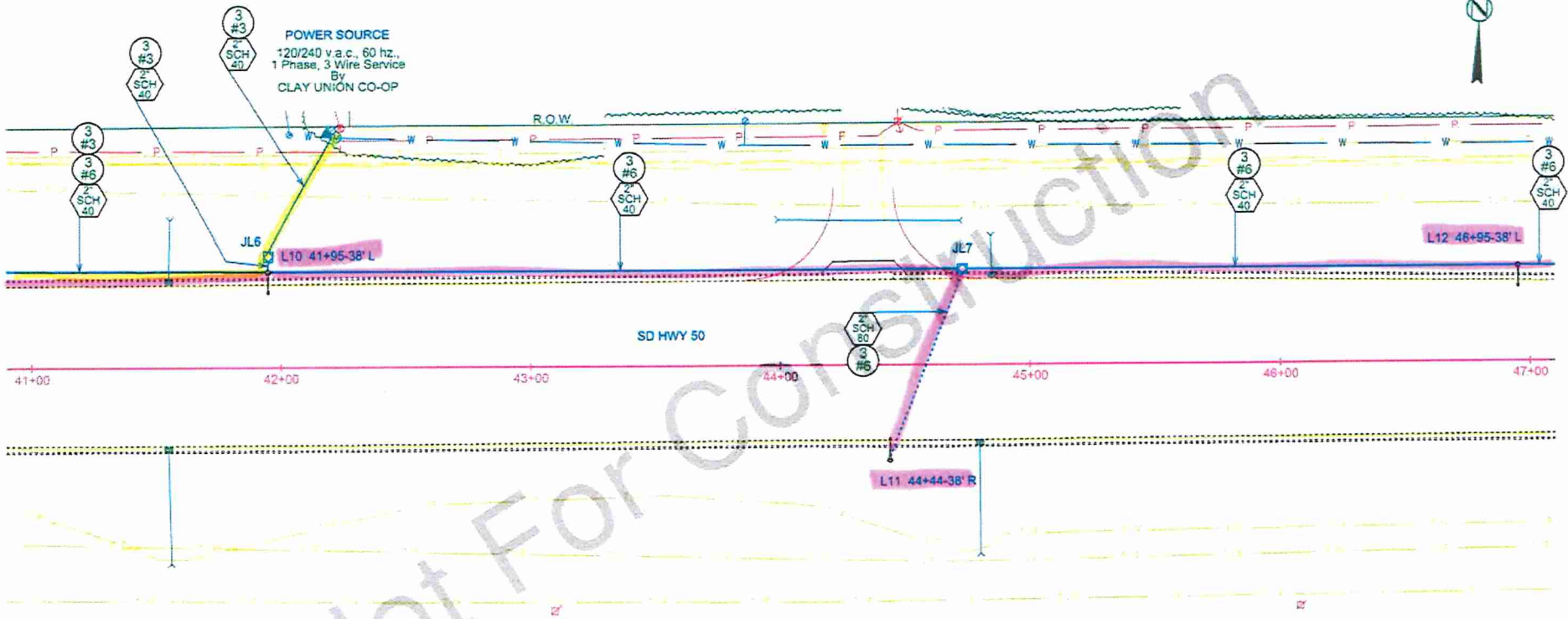

11/11/20
11/11/20
11/11/20

11/11/20

EXHIBIT 1

CONDUIT LAYOUT SD HWY 50

STATE OF SOUTH DAKOTA	PROJECT	SHEET	TOTAL
	NH 0050(117)407	L12	L37
Plotting Date: 06/25/2020			

SCALE
1" = 40'



POWER SOURCE
120/240 v.a.c., 60 hz.,
1 Phase, 3 Wire Service
By
CLAY UNION CO-OP

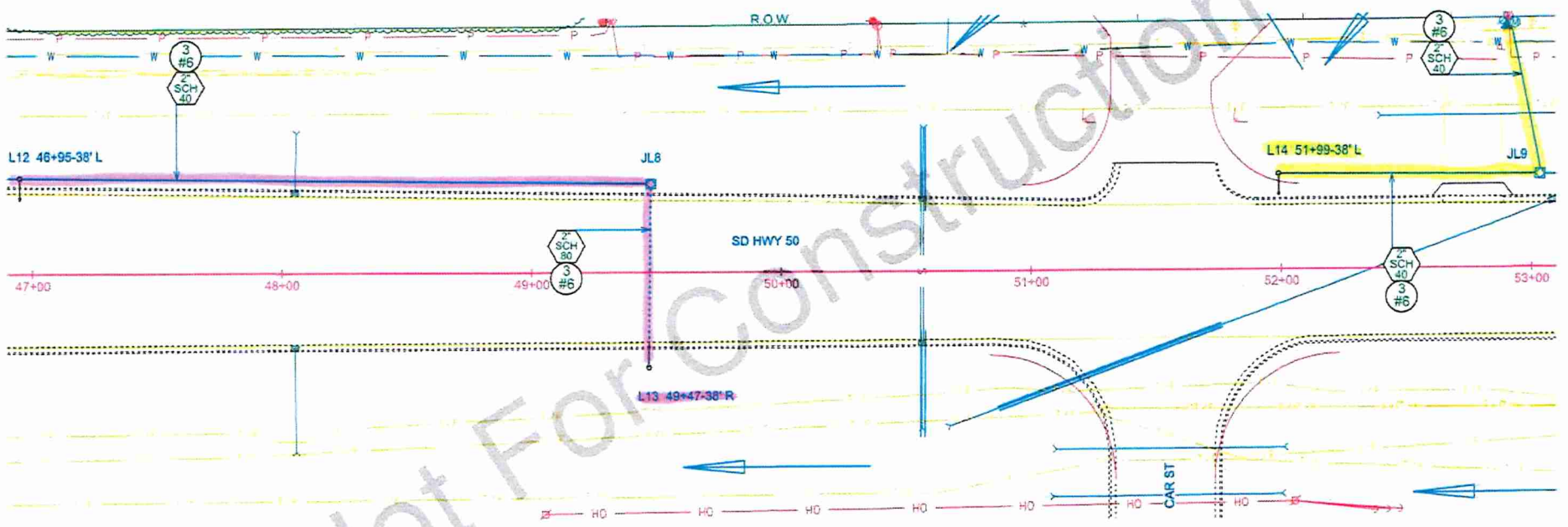

Not For Construction

Vertical text on the left margin: 11/11/2019 10:00 AM

Vertical text on the right margin: 11/11/2019 10:00 AM

EXHIBIT 1

CONDUIT LAYOUT SD HWY 50

STATE OF SOUTH DAKOTA	PROJECT	SHEET	TOTAL SHEETS
	NH 0050(117)407	L13	L37
Plotting Date: 06/25/2020			

POWER SOURCE
120/240 v.a.c., 60 Hz.,
1 Phase, 3 Wire Service
By
CLAY UNION CO-OP

SCALE
1" = 40'

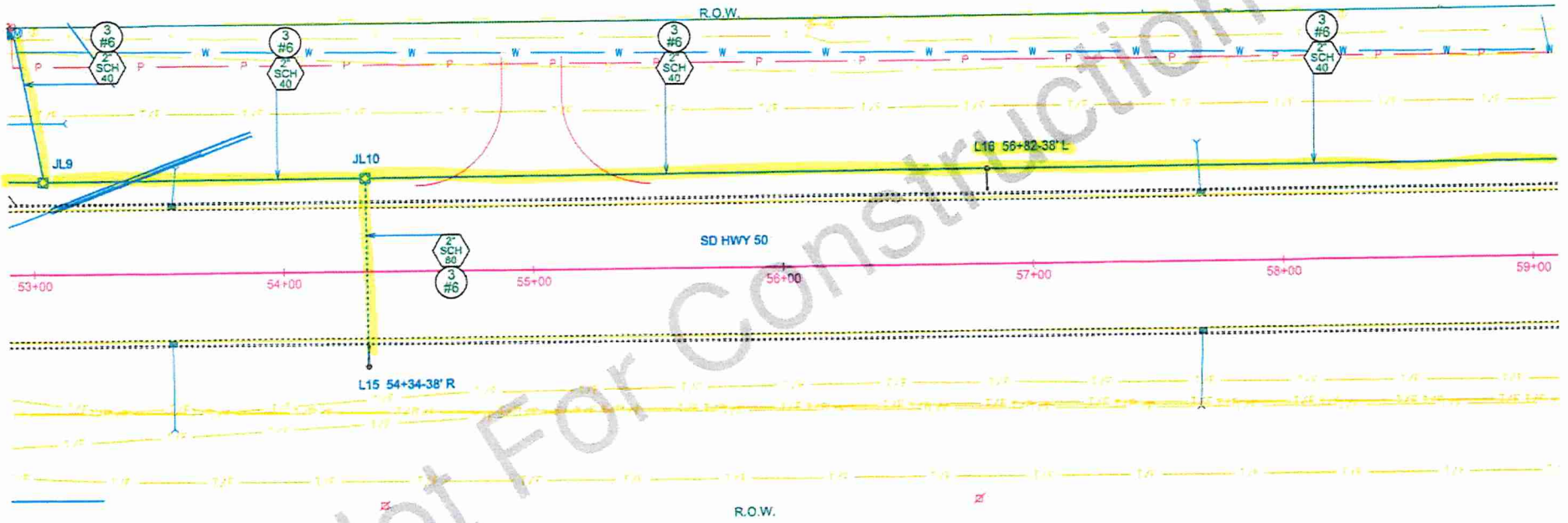

1:50

06/25/2020 11:11:26

1:50 06/25/2020 11:11:26

EXHIBIT 1

CONDUIT LAYOUT SD HWY 50

STATE OF SOUTH DAKOTA	PROJECT	SHEET	TOTAL SHEETS
	NH 0050(117)407	L14	L37
Plotting Date:		06/25/2020	

SCALE
1" = 40'

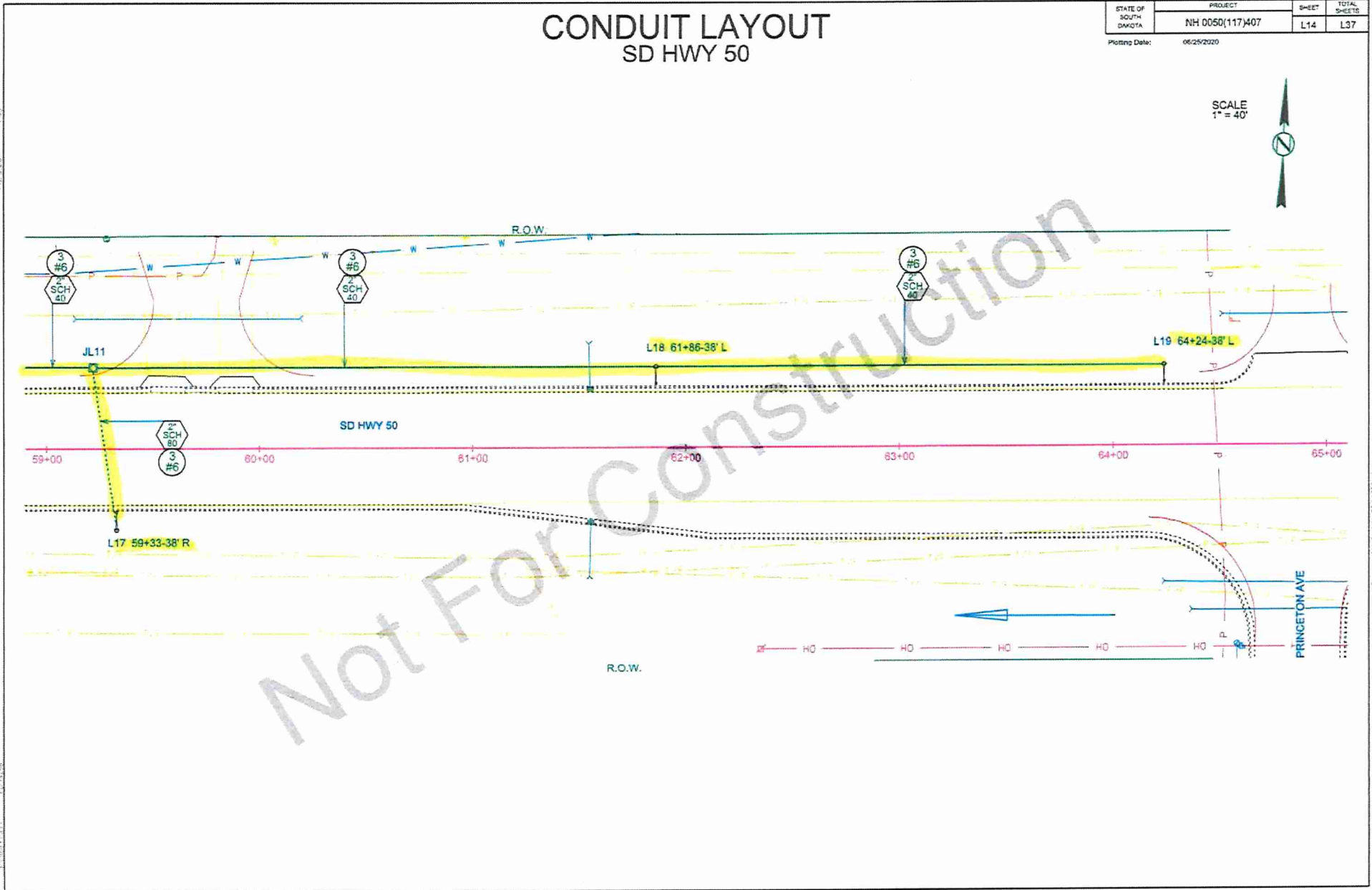

11/11/2019 10:54:46 AM

11/11/2019 10:54:46 AM

File: V:\p117\117407\117407.dwg

EXHIBIT 1

CONDUIT LAYOUT SD HWY 50

STATE OF SOUTH DAKOTA	PROJECT	SHEET	TOTAL
	NH 0050(117)407	L15	L37
Plotting Date: 06/25/2020			

SCALE
1" = 40'

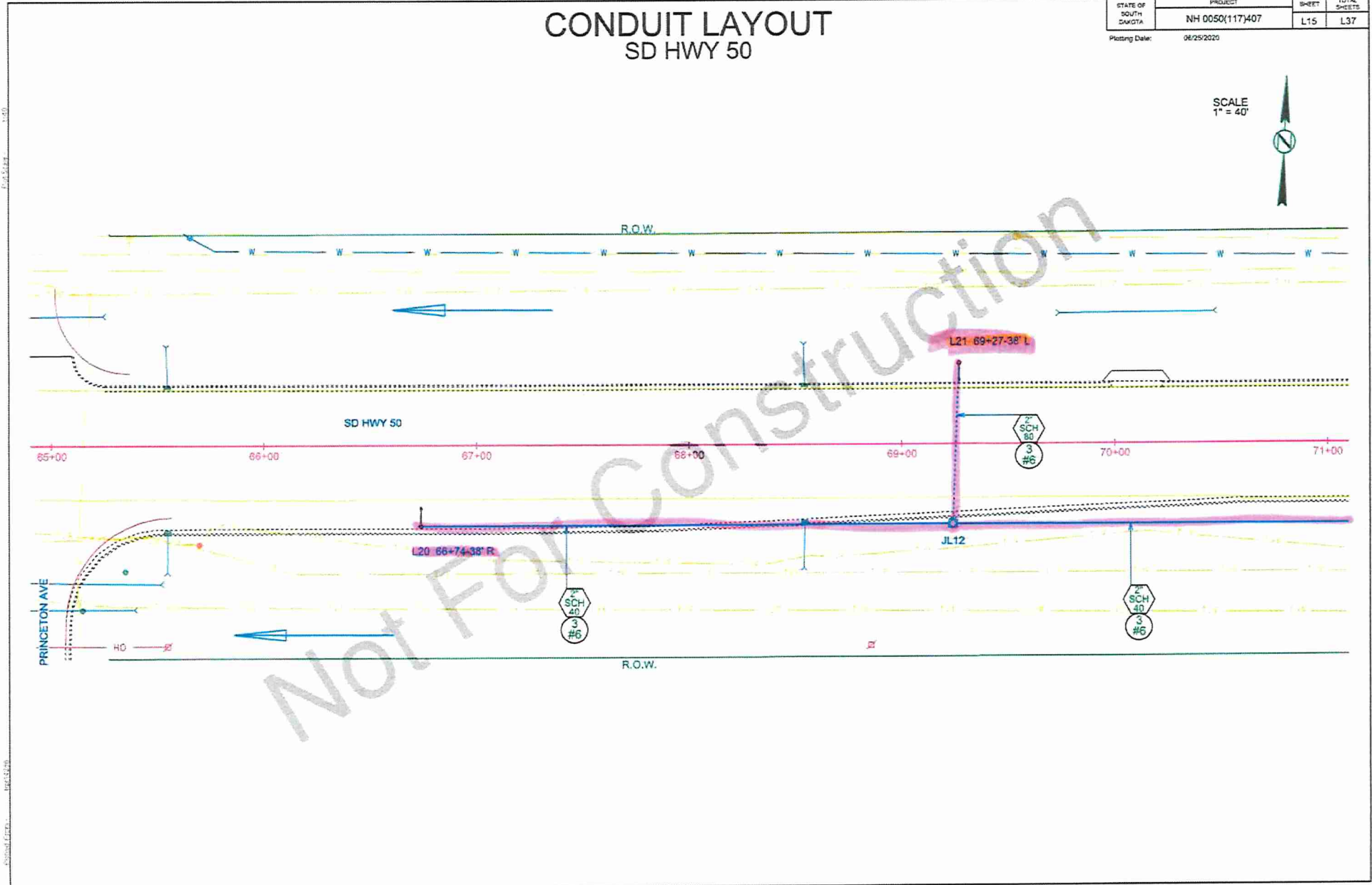

1:40
06/25/2020

06/25/2020

1:40
06/25/2020

EXHIBIT 1

CONDUIT LAYOUT SD HWY 50

STATE OF SOUTH DAKOTA	PROJECT	SHEET	TOTAL SHEETS
	NH 0050(117)407	L16	L37
Plotting Date: 06/25/2020			

SCALE
1" = 40'

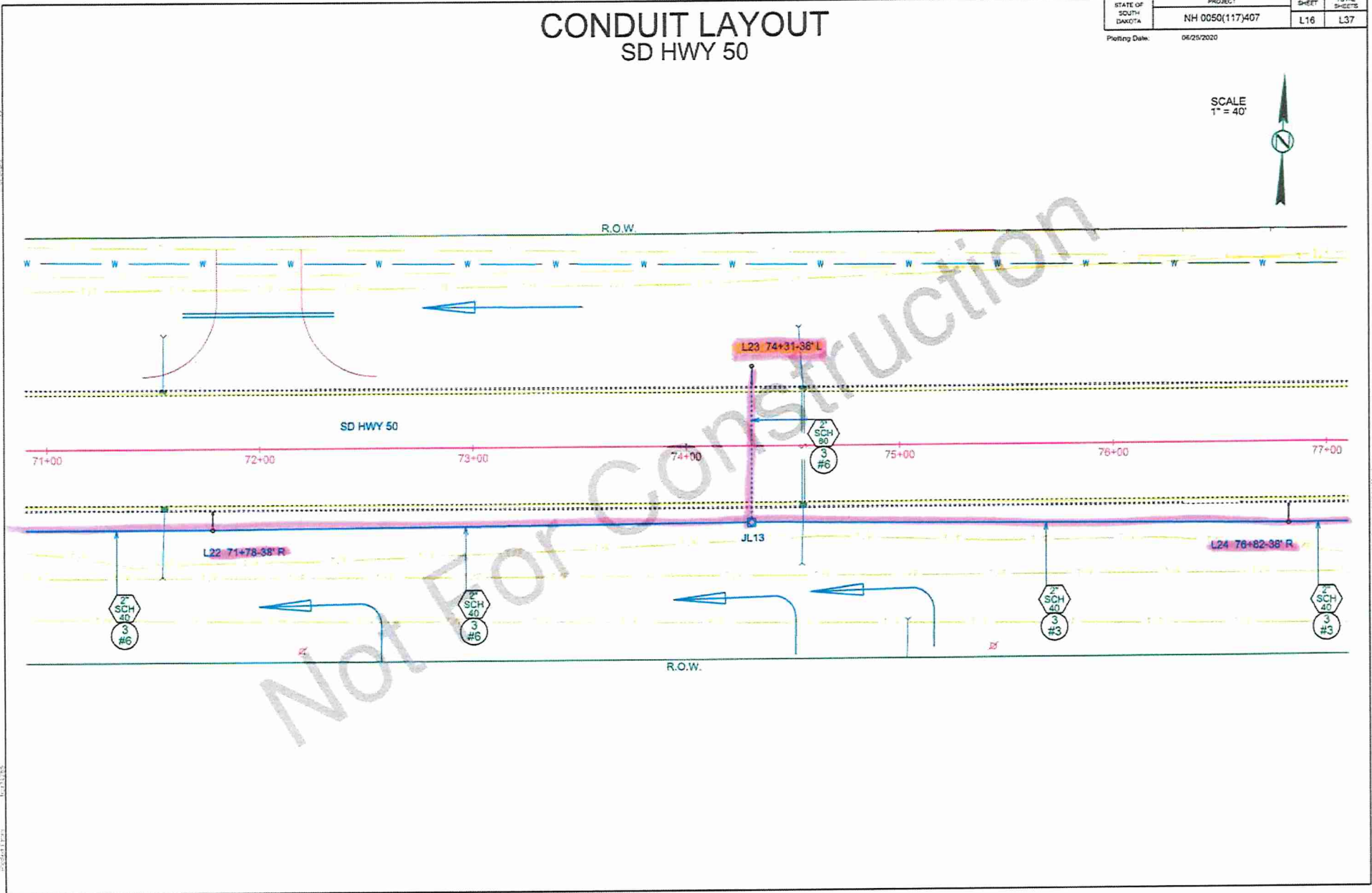

EXHIBIT 1

CONDUIT LAYOUT SD HWY 50

STATE OF SOUTH DAKOTA	PROJECT	SHEET	TOTAL SHEETS
	NH 0050(117)407	L17	L37
Plotting Date: 06/25/2023			

SCALE
1" = 40'

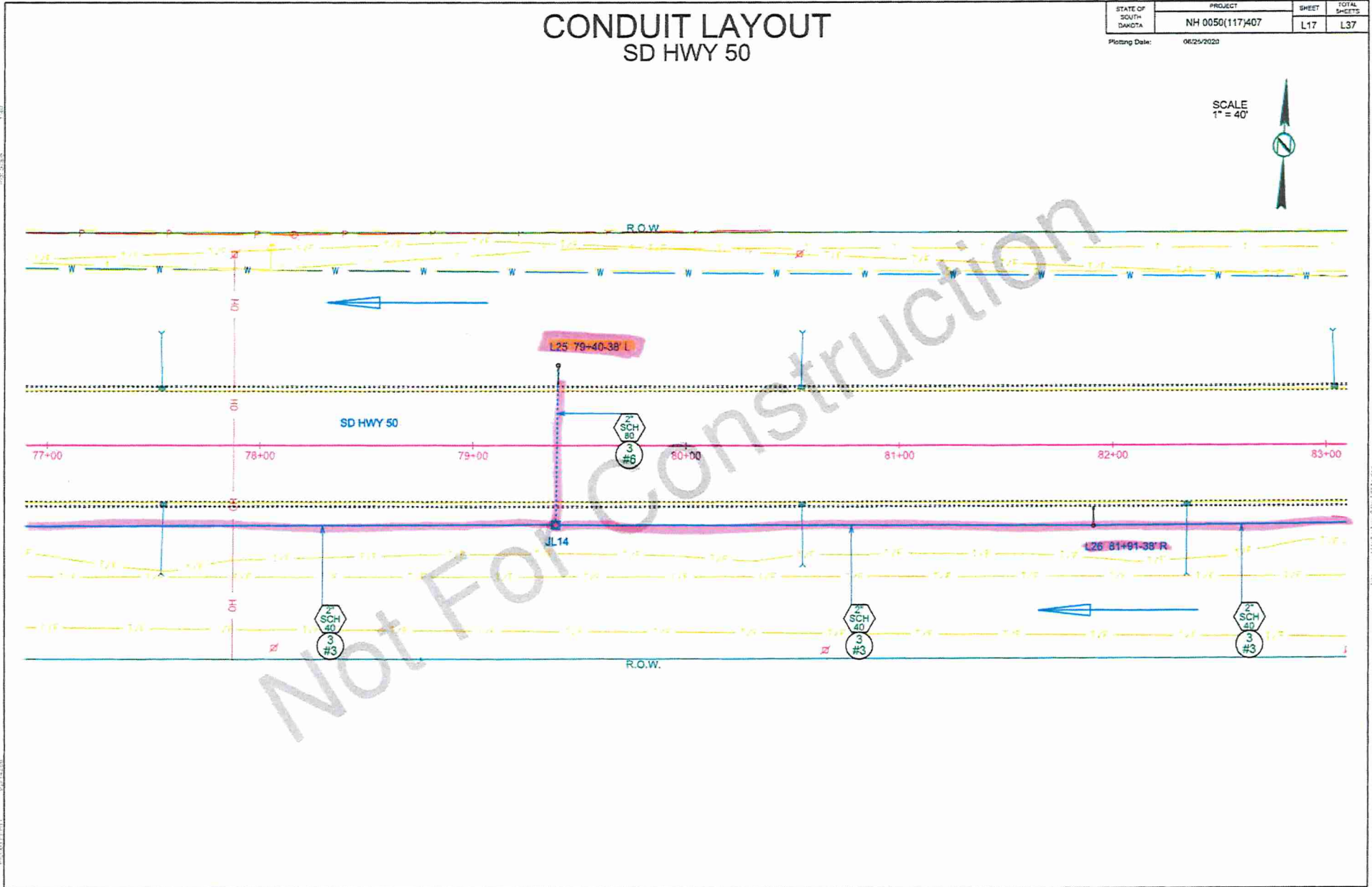
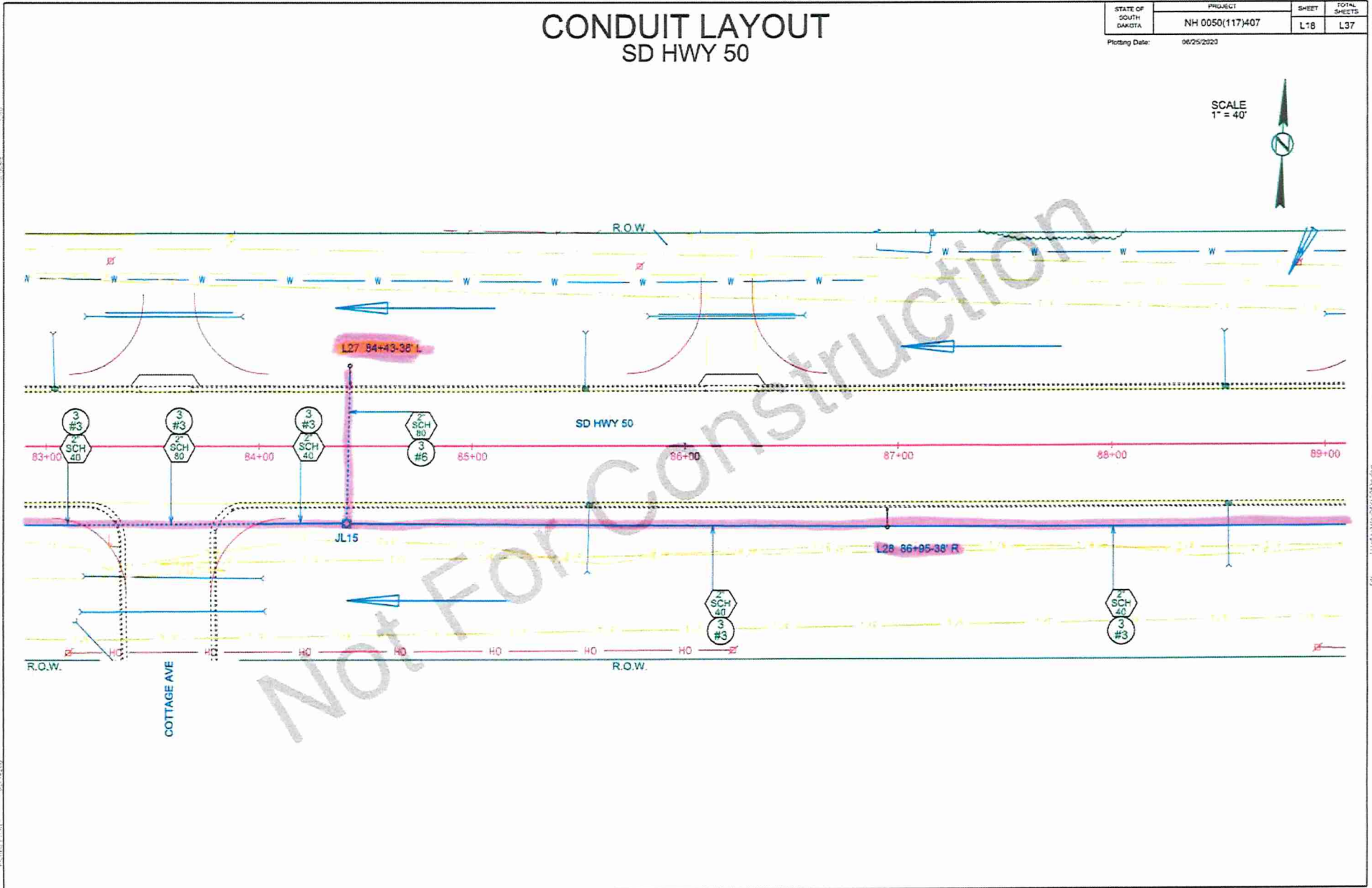

EXHIBIT 1

CONDUIT LAYOUT SD HWY 50

STATE OF SOUTH DAKOTA	PROJECT	SHEET	TOTAL SHEETS
	NH 0050(117)407	L18	L37
Plotting Date: 06/25/2020			

SCALE
1" = 40'



06/25/2020

06/25/2020

06/25/2020

06/25/2020

EXHIBIT 1

CONDUIT LAYOUT SD HWY 50

STATE OF SOUTH DAKOTA	PROJECT	SHEET	TOTAL SHEETS
	NH 0050(117)407	L19	L37
Plotting Date:	06/25/2020		

SCALE
1" = 40'



POWER SOURCE
120/240 v.a.c., 60 hz.,
1 Phase, 3 Wire Service
By
CITY OF VERMILLION

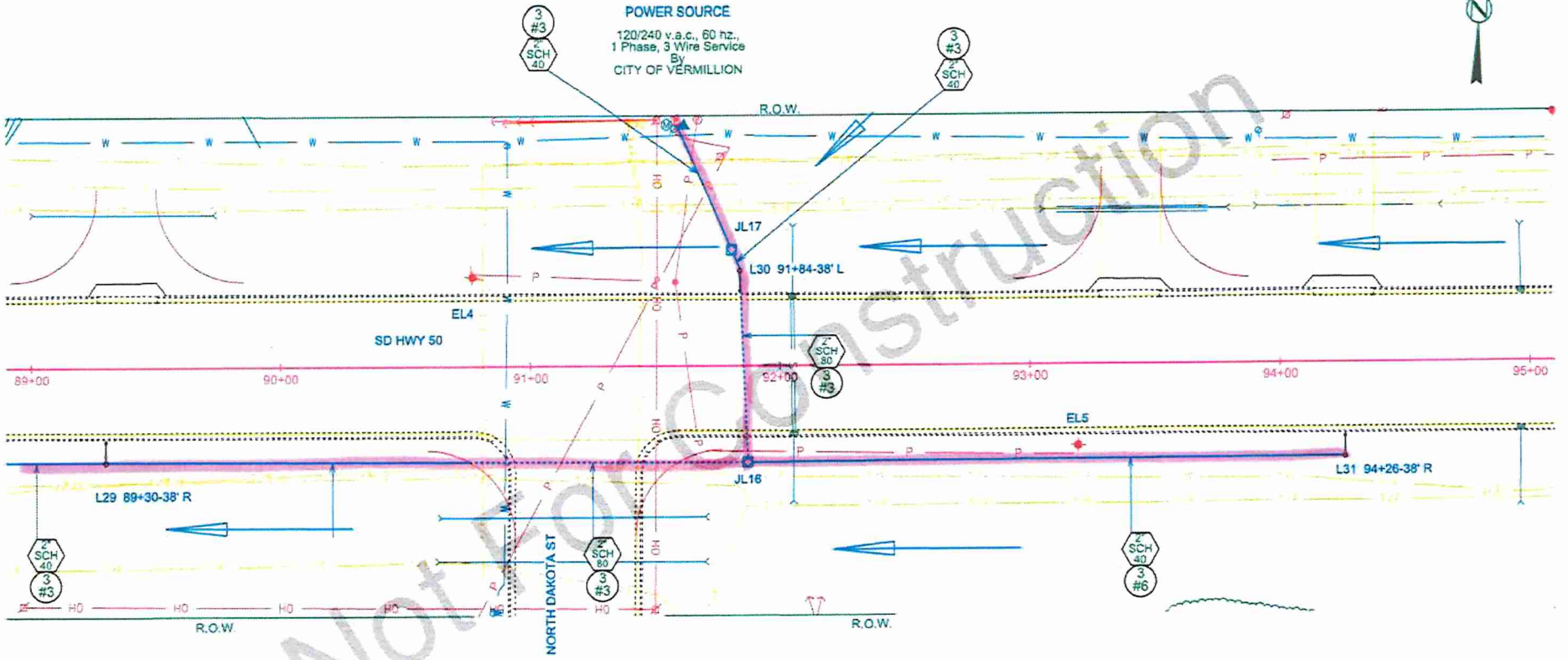

1 of 20
06/25/2020 10:40:00 AM
D:\Projects\117\407\19\19.L19.dwg

11/19/2020 10:40:00 AM

EXHIBIT 1

CONDUIT LAYOUT SD HWY 50

STATE OF SOUTH DAKOTA	PROJECT	SHEET	TOTAL
	NH 0050(117)407	L20	L37
Plotting Date:		06/25/2020	

SCALE
1" = 40'

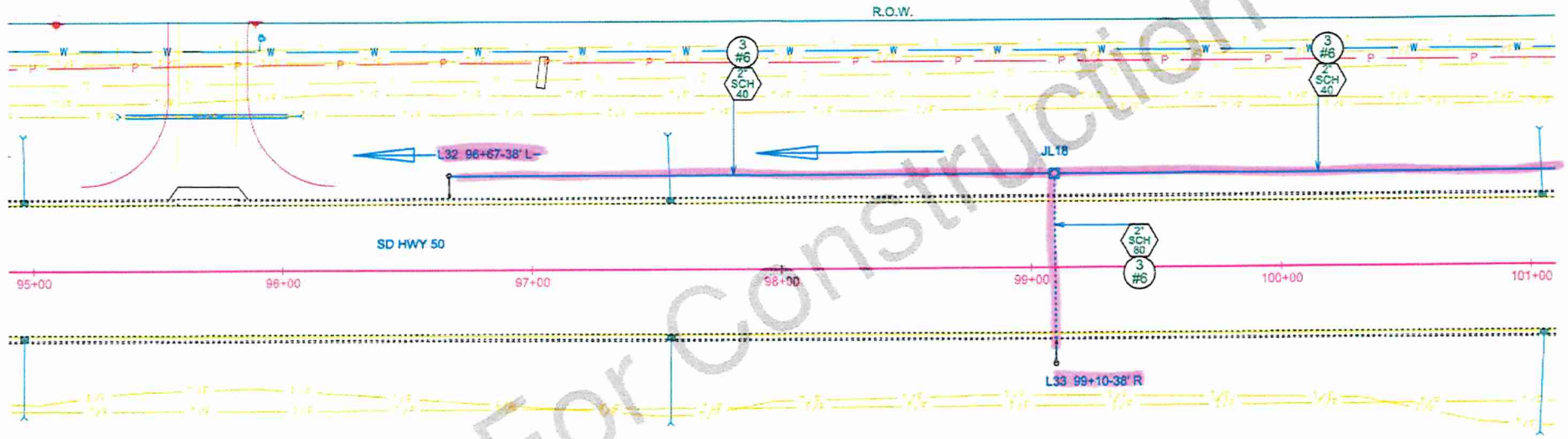

Not For Construction

06/25/2020

06/25/2020

File: U:\NH\0050\117\407.dwg

EXHIBIT 1

CONDUIT LAYOUT SD HWY 50

STATE OF SOUTH DAKOTA	PROJECT	SHEET	TOTAL SHEETS
	NH 0050(117)407	L21	L37
Plotting Date: 09/25/2020			

SCALE
1" = 40'



POWER SOURCE
120/240 v.a.c., 60 hz.,
1 Phase, 3 Wire Service
By
CITY OF VERMILLION

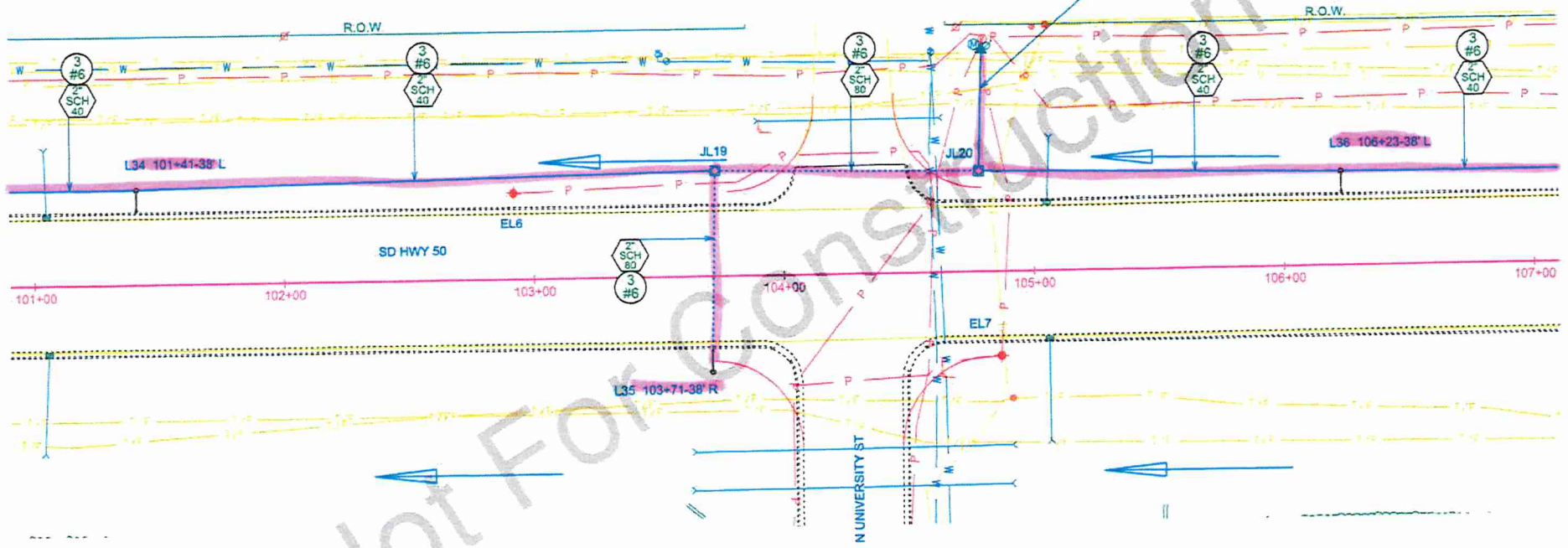

1:47
1:48
1:49
1:50
1:51
1:52
1:53
1:54
1:55
1:56
1:57
1:58
1:59
2:00
2:01
2:02
2:03
2:04
2:05
2:06
2:07
2:08
2:09
2:10
2:11
2:12
2:13
2:14
2:15
2:16
2:17
2:18
2:19
2:20
2:21
2:22
2:23
2:24
2:25
2:26
2:27
2:28
2:29
2:30
2:31
2:32
2:33
2:34
2:35
2:36
2:37
2:38
2:39
2:40
2:41
2:42
2:43
2:44
2:45
2:46
2:47
2:48
2:49
2:50
2:51
2:52
2:53
2:54
2:55
2:56
2:57
2:58
2:59
3:00
3:01
3:02
3:03
3:04
3:05
3:06
3:07
3:08
3:09
3:10
3:11
3:12
3:13
3:14
3:15
3:16
3:17
3:18
3:19
3:20
3:21
3:22
3:23
3:24
3:25
3:26
3:27
3:28
3:29
3:30
3:31
3:32
3:33
3:34
3:35
3:36
3:37
3:38
3:39
3:40
3:41
3:42
3:43
3:44
3:45
3:46
3:47
3:48
3:49
3:50
3:51
3:52
3:53
3:54
3:55
3:56
3:57
3:58
3:59
4:00
4:01
4:02
4:03
4:04
4:05
4:06
4:07
4:08
4:09
4:10
4:11
4:12
4:13
4:14
4:15
4:16
4:17
4:18
4:19
4:20
4:21
4:22
4:23
4:24
4:25
4:26
4:27
4:28
4:29
4:30
4:31
4:32
4:33
4:34
4:35
4:36
4:37
4:38
4:39
4:40
4:41
4:42
4:43
4:44
4:45
4:46
4:47
4:48
4:49
4:50
4:51
4:52
4:53
4:54
4:55
4:56
4:57
4:58
4:59
5:00
5:01
5:02
5:03
5:04
5:05
5:06
5:07
5:08
5:09
5:10
5:11
5:12
5:13
5:14
5:15
5:16
5:17
5:18
5:19
5:20
5:21
5:22
5:23
5:24
5:25
5:26
5:27
5:28
5:29
5:30
5:31
5:32
5:33
5:34
5:35
5:36
5:37
5:38
5:39
5:40
5:41
5:42
5:43
5:44
5:45
5:46
5:47
5:48
5:49
5:50
5:51
5:52
5:53
5:54
5:55
5:56
5:57
5:58
5:59
6:00
6:01
6:02
6:03
6:04
6:05
6:06
6:07
6:08
6:09
6:10
6:11
6:12
6:13
6:14
6:15
6:16
6:17
6:18
6:19
6:20
6:21
6:22
6:23
6:24
6:25
6:26
6:27
6:28
6:29
6:30
6:31
6:32
6:33
6:34
6:35
6:36
6:37
6:38
6:39
6:40
6:41
6:42
6:43
6:44
6:45
6:46
6:47
6:48
6:49
6:50
6:51
6:52
6:53
6:54
6:55
6:56
6:57
6:58
6:59
7:00
7:01
7:02
7:03
7:04
7:05
7:06
7:07
7:08
7:09
7:10
7:11
7:12
7:13
7:14
7:15
7:16
7:17
7:18
7:19
7:20
7:21
7:22
7:23
7:24
7:25
7:26
7:27
7:28
7:29
7:30
7:31
7:32
7:33
7:34
7:35
7:36
7:37
7:38
7:39
7:40
7:41
7:42
7:43
7:44
7:45
7:46
7:47
7:48
7:49
7:50
7:51
7:52
7:53
7:54
7:55
7:56
7:57
7:58
7:59
8:00
8:01
8:02
8:03
8:04
8:05
8:06
8:07
8:08
8:09
8:10
8:11
8:12
8:13
8:14
8:15
8:16
8:17
8:18
8:19
8:20
8:21
8:22
8:23
8:24
8:25
8:26
8:27
8:28
8:29
8:30
8:31
8:32
8:33
8:34
8:35
8:36
8:37
8:38
8:39
8:40
8:41
8:42
8:43
8:44
8:45
8:46
8:47
8:48
8:49
8:50
8:51
8:52
8:53
8:54
8:55
8:56
8:57
8:58
8:59
9:00
9:01
9:02
9:03
9:04
9:05
9:06
9:07
9:08
9:09
9:10
9:11
9:12
9:13
9:14
9:15
9:16
9:17
9:18
9:19
9:20
9:21
9:22
9:23
9:24
9:25
9:26
9:27
9:28
9:29
9:30
9:31
9:32
9:33
9:34
9:35
9:36
9:37
9:38
9:39
9:40
9:41
9:42
9:43
9:44
9:45
9:46
9:47
9:48
9:49
9:50
9:51
9:52
9:53
9:54
9:55
9:56
9:57
9:58
9:59
10:00
10:01
10:02
10:03
10:04
10:05
10:06
10:07
10:08
10:09
10:10
10:11
10:12
10:13
10:14
10:15
10:16
10:17
10:18
10:19
10:20
10:21
10:22
10:23
10:24
10:25
10:26
10:27
10:28
10:29
10:30
10:31
10:32
10:33
10:34
10:35
10:36
10:37
10:38
10:39
10:40
10:41
10:42
10:43
10:44
10:45
10:46
10:47
10:48
10:49
10:50
10:51
10:52
10:53
10:54
10:55
10:56
10:57
10:58
10:59
11:00
11:01
11:02
11:03
11:04
11:05
11:06
11:07
11:08
11:09
11:10
11:11
11:12
11:13
11:14
11:15
11:16
11:17
11:18
11:19
11:20
11:21
11:22
11:23
11:24
11:25
11:26
11:27
11:28
11:29
11:30
11:31
11:32
11:33
11:34
11:35
11:36
11:37
11:38
11:39
11:40
11:41
11:42
11:43
11:44
11:45
11:46
11:47
11:48
11:49
11:50
11:51
11:52
11:53
11:54
11:55
11:56
11:57
11:58
11:59
12:00
12:01
12:02
12:03
12:04
12:05
12:06
12:07
12:08
12:09
12:10
12:11
12:12
12:13
12:14
12:15
12:16
12:17
12:18
12:19
12:20
12:21
12:22
12:23
12:24
12:25
12:26
12:27
12:28
12:29
12:30
12:31
12:32
12:33
12:34
12:35
12:36
12:37
12:38
12:39
12:40
12:41
12:42
12:43
12:44
12:45
12:46
12:47
12:48
12:49
12:50
12:51
12:52
12:53
12:54
12:55
12:56
12:57
12:58
12:59
13:00
13:01
13:02
13:03
13:04
13:05
13:06
13:07
13:08
13:09
13:10
13:11
13:12
13:13
13:14
13:15
13:16
13:17
13:18
13:19
13:20
13:21
13:22
13:23
13:24
13:25
13:26
13:27
13:28
13:29
13:30
13:31
13:32
13:33
13:34
13:35
13:36
13:37
13:38
13:39
13:40
13:41
13:42
13:43
13:44
13:45
13:46
13:47
13:48
13:49
13:50
13:51
13:52
13:53
13:54
13:55
13:56
13:57
13:58
13:59
14:00
14:01
14:02
14:03
14:04
14:05
14:06
14:07
14:08
14:09
14:10
14:11
14:12
14:13
14:14
14:15
14:16
14:17
14:18
14:19
14:20
14:21
14:22
14:23
14:24
14:25
14:26
14:27
14:28
14:29
14:30
14:31
14:32
14:33
14:34
14:35
14:36
14:37
14:38
14:39
14:40
14:41
14:42
14:43
14:44
14:45
14:46
14:47
14:48
14:49
14:50
14:51
14:52
14:53
14:54
14:55
14:56
14:57
14:58
14:59
15:00
15:01
15:02
15:03
15:04
15:05
15:06
15:07
15:08
15:09
15:10
15:11
15:12
15:13
15:14
15:15
15:16
15:17
15:18
15:19
15:20
15:21
15:22
15:23
15:24
15:25
15:26
15:27
15:28
15:29
15:30
15:31
15:32
15:33
15:34
15:35
15:36
15:37
15:38
15:39
15:40
15:41
15:42
15:43
15:44
15:45
15:46
15:47
15:48
15:49
15:50
15:51
15:52
15:53
15:54
15:55
15:56
15:57
15:58
15:59
16:00
16:01
16:02
16:03
16:04
16:05
16:06
16:07
16:08
16:09
16:10
16:11
16:12
16:13
16:14
16:15
16:16
16:17
16:18
16:19
16:20
16:21
16:22
16:23
16:24
16:25
16:26
16:27
16:28
16:29
16:30
16:31
16:32
16:33
16:34
16:35
16:36
16:37
16:38
16:39
16:40
16:41
16:42
16:43
16:44
16:45
16:46
16:47
16:48
16:49
16:50
16:51
16:52
16:53
16:54
16:55
16:56
16:57
16:58
16:59
17:00
17:01
17:02
17:03
17:04
17:05
17:06
17:07
17:08
17:09
17:10
17:11
17:12
17:13
17:14
17:15
17:16
17:17
17:18
17:19
17:20
17:21
17:22
17:23
17:24
17:25
17:26
17:27
17:28
17:29
17:30
17:31
17:32
17:33
17:34
17:35
17:36
17:37
17:38
17:39
17:40
17:41
17:42
17:43
17:44
17:45
17:46
17:47
17:48
17:49
17:50
17:51
17:52
17:53
17:54
17:55
17:56
17:57
17:58
17:59
18:00
18:01
18:02
18:03
18:04
18:05
18:06
18:07
18:08
18:09
18:10
18:11
18:12
18:13
18:14
18:15
18:16
18:17
18:18
18:19
18:20
18:21
18:22
18:23
18:24
18:25
18:26
18:27
18:28
18:29
18:30
18:31
18:32
18:33
18:34
18:35
18:36
18:37
18:38
18:39
18:40
18:41
18:42
18:43
18:44
18:45
18:46
18:47
18:48
18:49
18:50
18:51
18:52
18:53
18:54
18:55
18:56
18:57
18:58
18:59
19:00
19:01
19:02
19:03
19:04
19:05
19:06
19:07
19:08
19:09
19:10
19:11
19:12
19:13
19:14
19:15
19:16
19:17
19:18
19:19
19:20
19:21
19:22
19:23
19:24
19:25
19:26
19:27
19:28
19:29
19:30
19:31
19:32
19:33
19:34
19:35
19:36
19:37
19:38
19:39
19:40
19:41
19:42
19:43
19:44
19:45
19:46
19:47
19:48
19:49
19:50
19:51
19:52
19:53
19:54
19:55
19:56
19:57
19:58
19:59
20:00
20:01
20:02
20:03
20:04
20:05
20:06
20:07
20:08
20:09
20:10
20:11
20:12
20:13
20:14
20:15
20:16
20:17
20:18
20:19
20:20
20:21
20:22
20:23
20:24
20:25
20:26
20:27
20:28
20:29
20:30
20:31
20:32
20:33
20:34
20:35
20:36
20:37
20:38
20:39
20:40
20:41
20:42
20:43
20:44
20:45
20:46
20:47
20:48
20:49
20:50
20:51
20:52
20:53
20:54
20:55
20:56
20:57
20:58
20:59
21:00
21:01
21:02
21:03
21:04
21:05
21:06
21:07
21:08
21:09
21:10
21:11
21:12
21:13
21:14
21:15
21:16
21:17
21:18
21:19
21:20
21:21
21:22
21:23
21:24
21:25
21:26
21:27
21:28
21:29
21:30
21:31
21:32
21:33
21:34
21:35
21:36
21:37
21:38
21:39
21:40
21:41
21:42
21:43
21:44
21:45
21:46
21:47
21:48
21:49
21:50
21:51
21:52
21:53
21:54
21:55
21:56
21:57
21:58
21:59
22:00
22:01
22:02
22:03
22:04
22:05
22:06
22:07
22:08
22:09
22:10
22:11
22:12
22:13
22:14
22:15
22:16
22:17
22:18
22:19
22:20
22:21
22:22
22:23
22:24
22:25
22:26
22:27
22:28
22:29
22:30
22:31
22:32
22:33
22:34
22:35
22:36
22:37
22:38
22:39
22:40
22:41
22:42
22:43
22:44
22:45
22:46
22:47
22:48
22:49
22:50
22:51
22:52
22:53
22:54
22:55
22:56
22:57
22:58
22:59
23:00
23:01
23:02
23:03
23:04
23:05
23:06
23:07
23:08
23:09
23:10
23:11
23:12
23:13
23:14
23:15
23:16
23:17
23:18
23:19
23:20
23:21
23:22
23:23
23:24
23:25
23:26
23:27
23:28
23:29
23:30
23:31
23:32
23:33
23:34
23:35
23:36
23:37
23:38
23:39
23:40
23:41
23:42
23:43
23:44
23:45
23:46
23:47
23:48
23:49
23:50
23:51
23:52
23:53
23:54
23:55
23:56
23:57
23:58
23:59
24:00

File: \\snp\p\scap\117\101.dwg

EXHIBIT 1

CONDUIT LAYOUT SD HWY 50

STATE OF SOUTH DAKOTA	PROJECT NH 0050(117)407	TOTAL SHEETS
PLANNING DATE: 06/25/2020		L24 L37

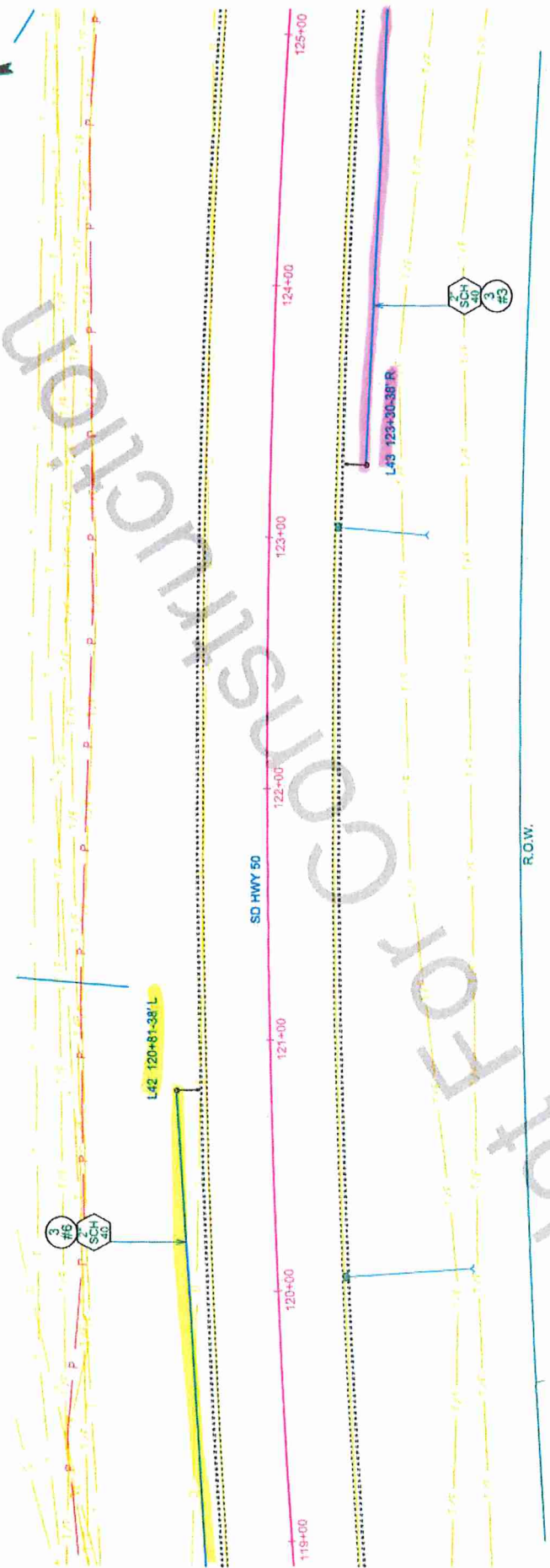

EXHIBIT 1

CONDUIT LAYOUT SD HWY 50

STATE OF SOUTH DAKOTA	PROJECT	SHEET	TOTAL SHEETS
	NH 0050(117)407	L26	L37

Plotting Date: 06/25/2020

SCALE
1" = 40'

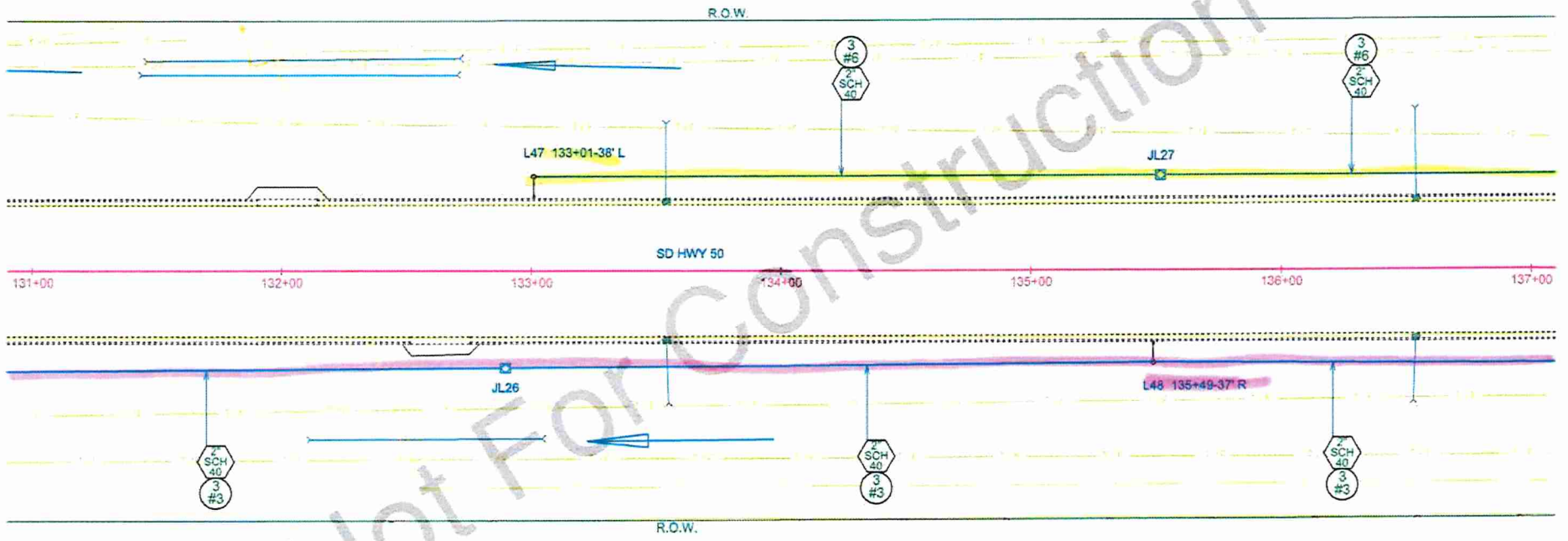

1:10
11/13/2020
11/13/2020

11/13/2020

EXHIBIT 1

CONDUIT LAYOUT SD HWY 50

STATE OF SOUTH DAKOTA	PROJECT	SHEET	TOTAL SHEETS
	NH 0050(117)407	L27	L37

Plotting Date: 06/25/2020

POWER SOURCE
120/240 v.a.c., 60 hz.,
1 Phase, 3 Wire Service
By
CLAY UNION CO-OP

SCALE
1" = 40'

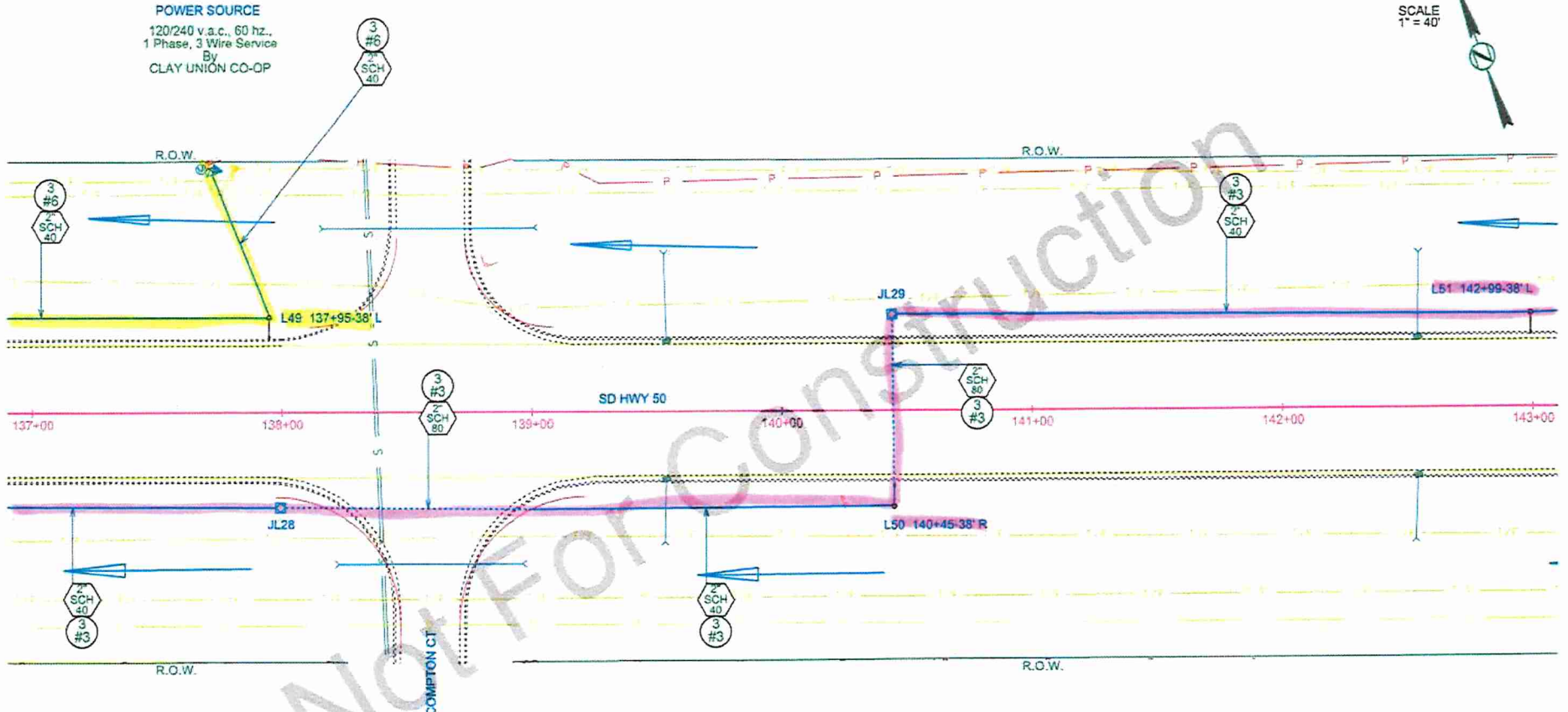

NOT FOR CONSTRUCTION

Drawn by: [unreadable] Date: [unreadable]

File: [unreadable]

EXHIBIT 1

CONDUIT LAYOUT SD HWY 50

STATE OF SOUTH DAKOTA	PROJECT	SHEET	TOTAL SHEETS
	NH 0050(117)407	L28	L37

Plotting Date: 06/25/2020

SCALE
1" = 40'



POWER SOURCE
120/240 v.a.c., 60 hz.,
1 Phase, 3 Wire Service
By
CITY OF VERMILLION

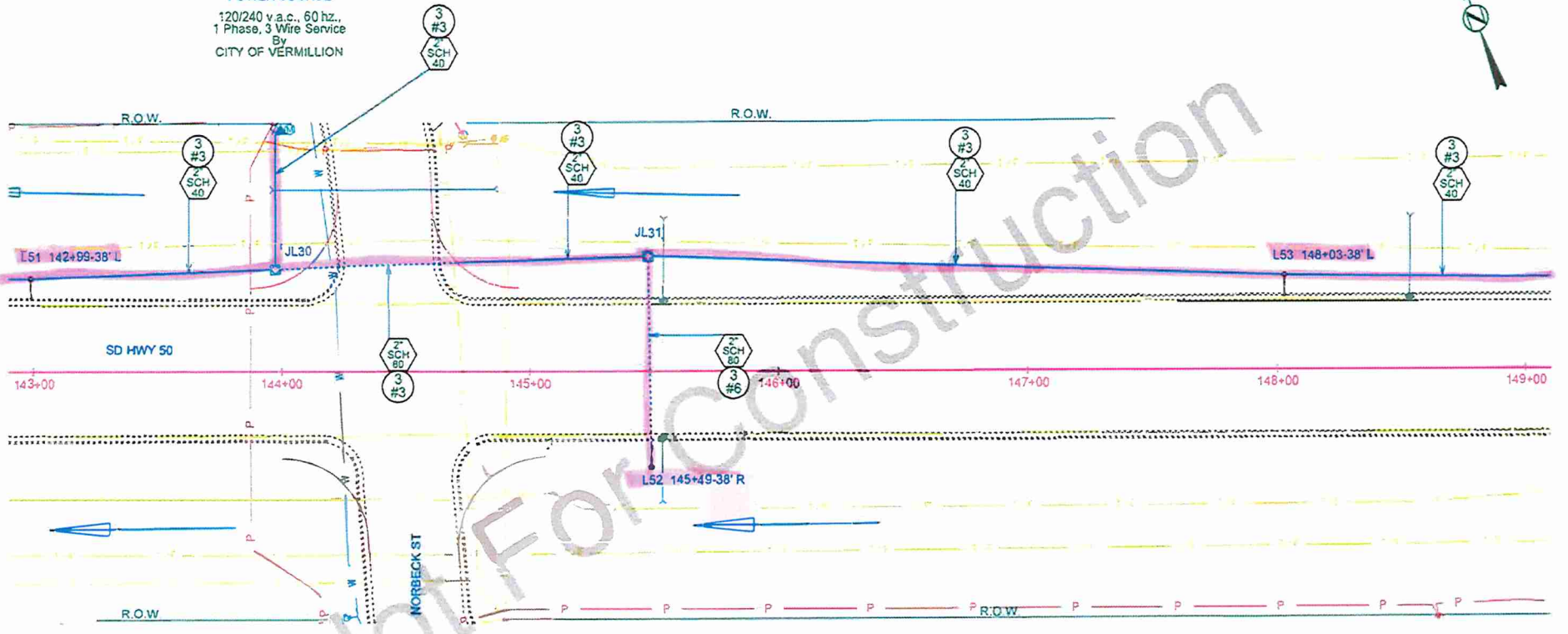

Not For Construction

EXHIBIT 1

CONDUIT LAYOUT SD HWY 50

STATE OF SOUTH DAKOTA	PROJECT	SHEET	TOTAL SHEETS
	NH 0050(117)407	L29	L37

Plotting Date: 06/25/2020

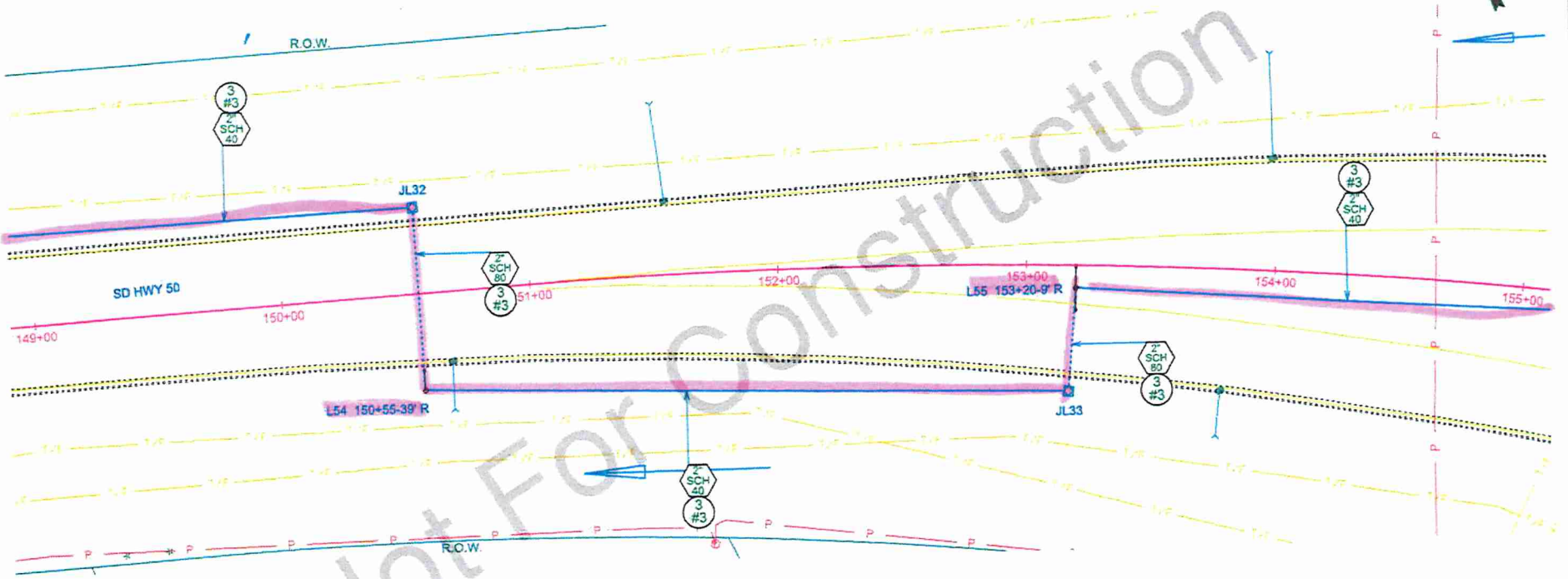
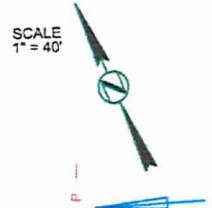

Not For Construction

Plotting Date: 06/25/2020

Plotting Date: 06/25/2020

EXHIBIT 1

CONDUIT LAYOUT SD HWY 50

STATE OF SOUTH DAKOTA	PROJECT	SHEET	TOTAL SHEETS
	NH 0050(117)407	L30	L37
Posting Date:		06/25/2020	

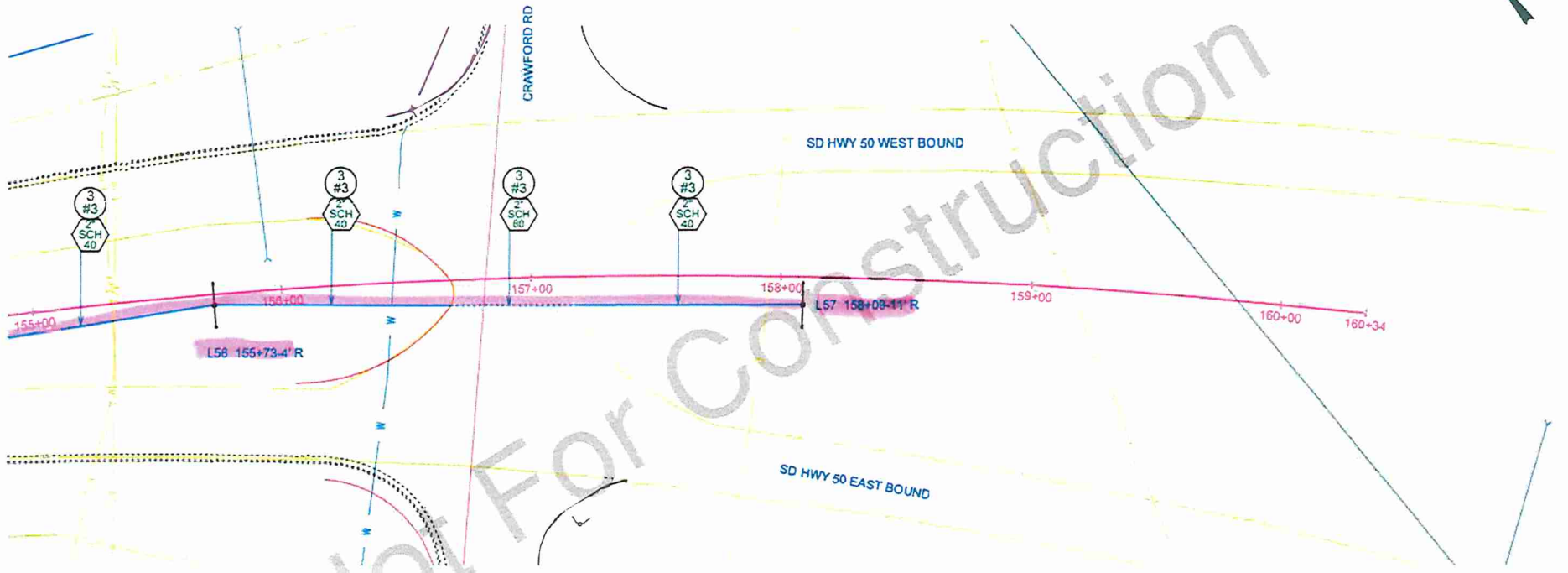
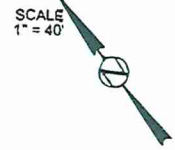

Not For Construction