

ELEVATIONS SHOWN IN FEET - VERTICAL = 10x HORIZONTAL SCALE

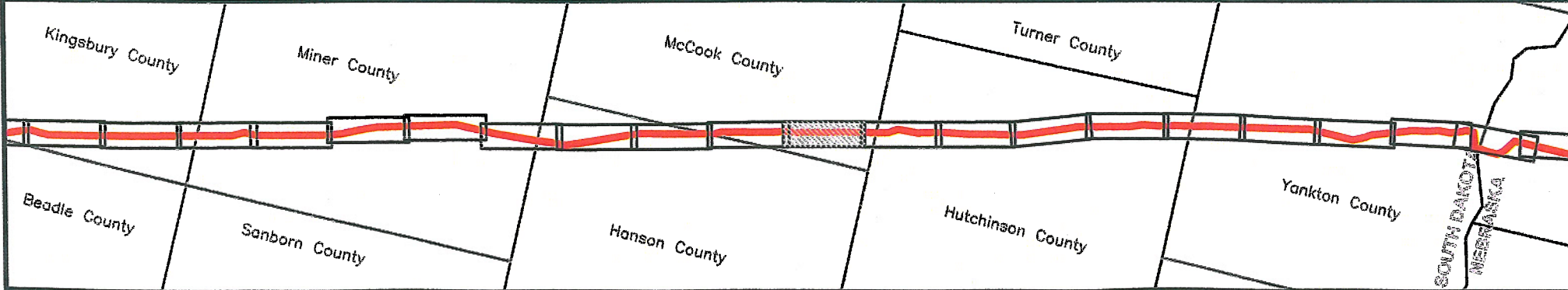
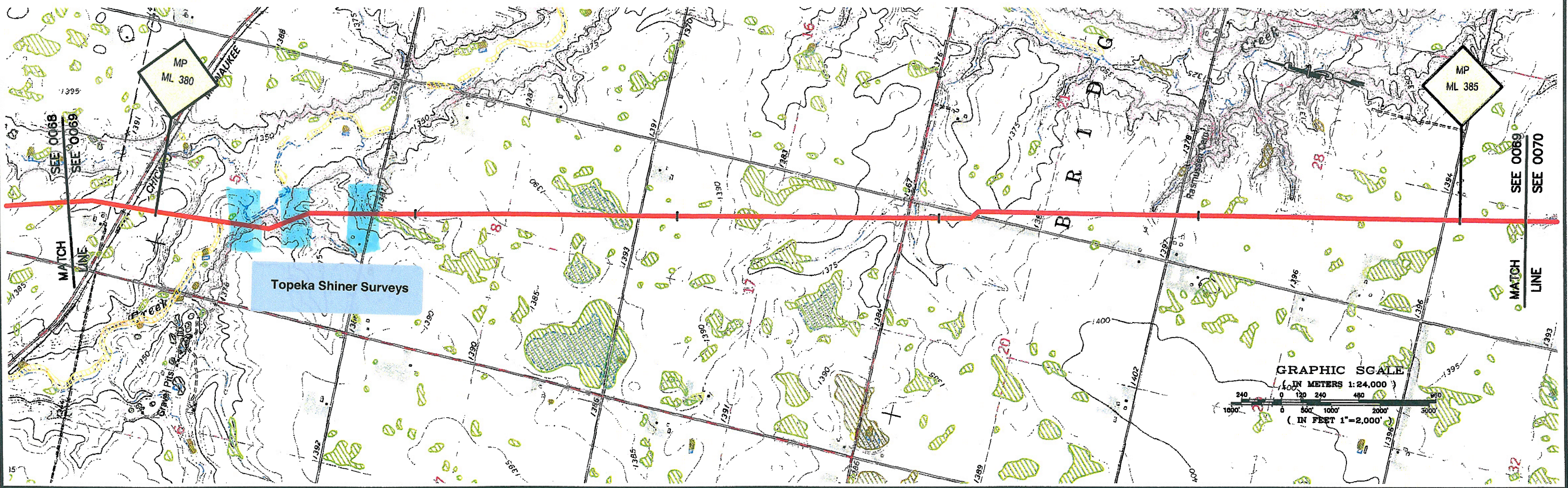
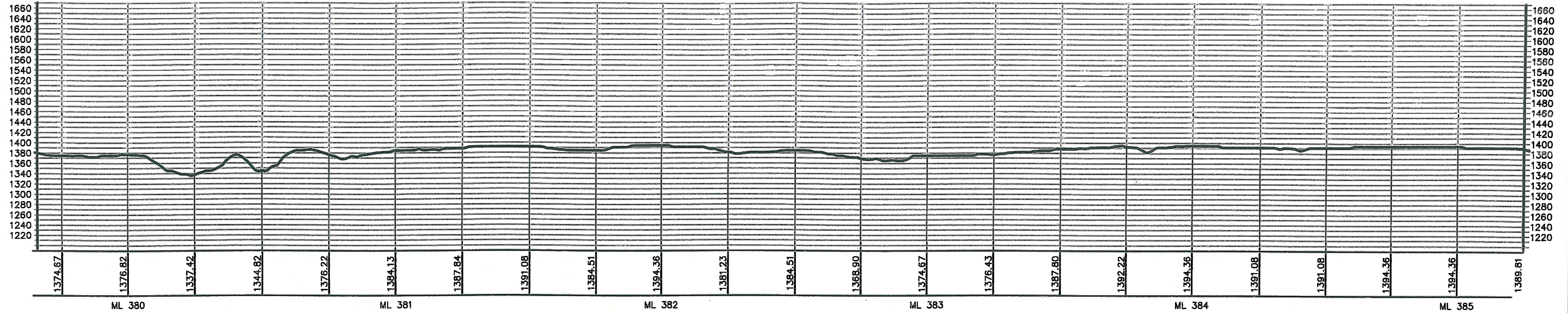

PREPARED BY:
TROW ENGINEERING CONSULTANTS, INC.
 1300 Metropolitan Boulevard, Suite 200
 Tallahassee, Florida 32308
 Phone: 1-850-385-5441
 Fax: 1-850-385-5523

NO.	REVISION	DATE

DRAWING NUMBER	DRAWN BY	CHECKED BY
K-46-P-900-A-0030	BEK	BLS

TransCanada
In business to deliver

**KEYSTONE PIPELINE PROJECT
 PROPOSED ROUTE BOOK**

MAP PARAMETERS
 PROJECTION: NAD83, UTM: 14N
 SCALE: 1:24000, 1" = 2,000'

PROJECT:	50388E
SHEET:	0069
APPROVED BY:	RG
ISSUED FOR DEPARTMENT OF STATE FILING	MAR.13.06

LAST PLOT DATE:
 Tue, 07 Mar 2006 - 11:44pm

X:\Drawings\50388A\KEYSTONE\DRAWING FILES\DRAWINGS\KWK MAP BOOKS\MAR 2006 ISSUE\02-PROFILES\REVISED UTM 14 SOUTH DAKOTA\K-46-P-900-A-0030-A-0030-002.dwg 3/7/2006 11:38:07 PM EST

ELEVATIONS SHOWN IN FEET - VERTICAL = 10x HORIZONTAL SCALE

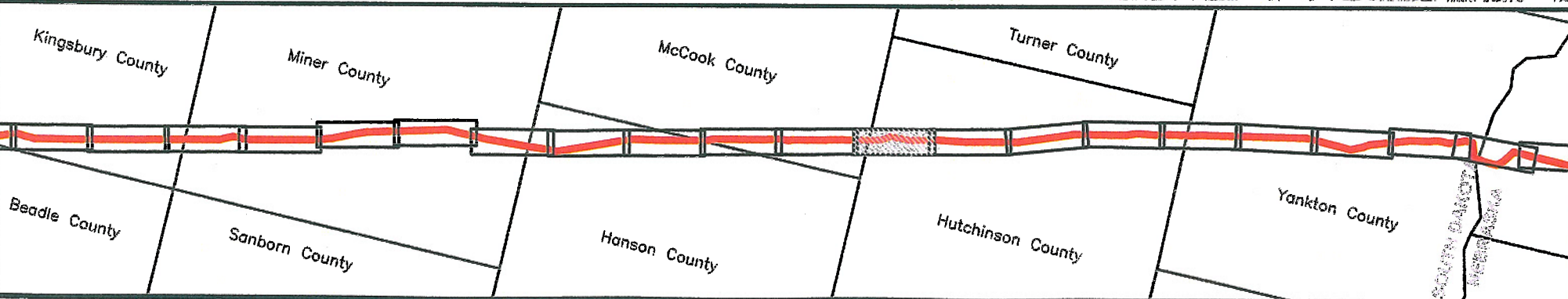
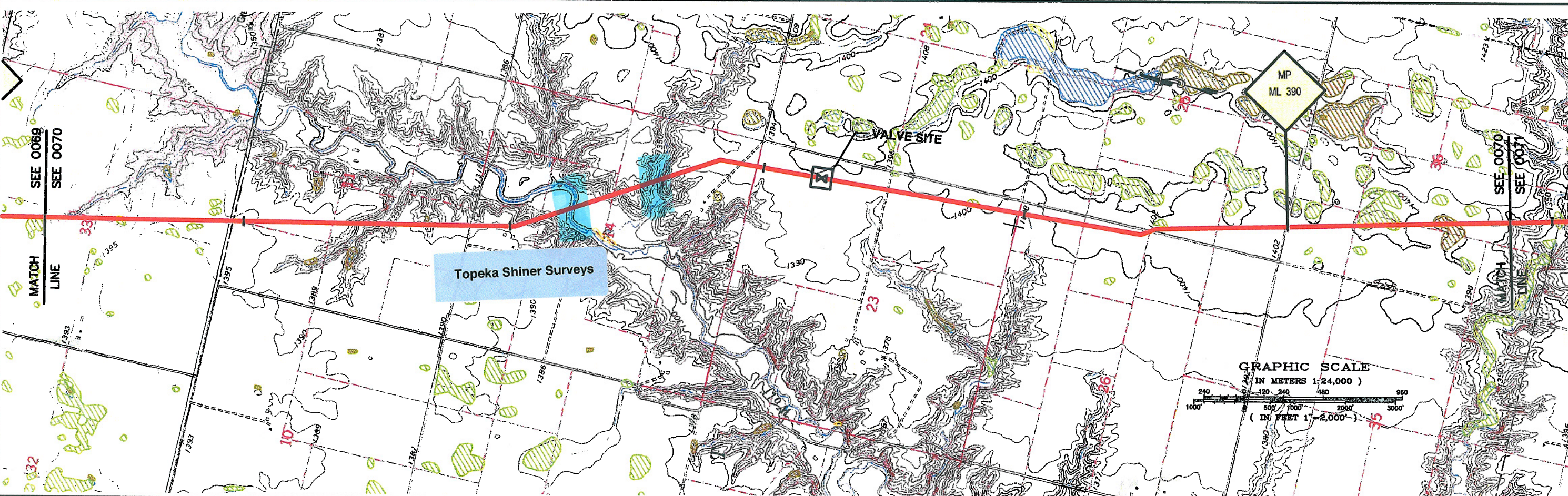
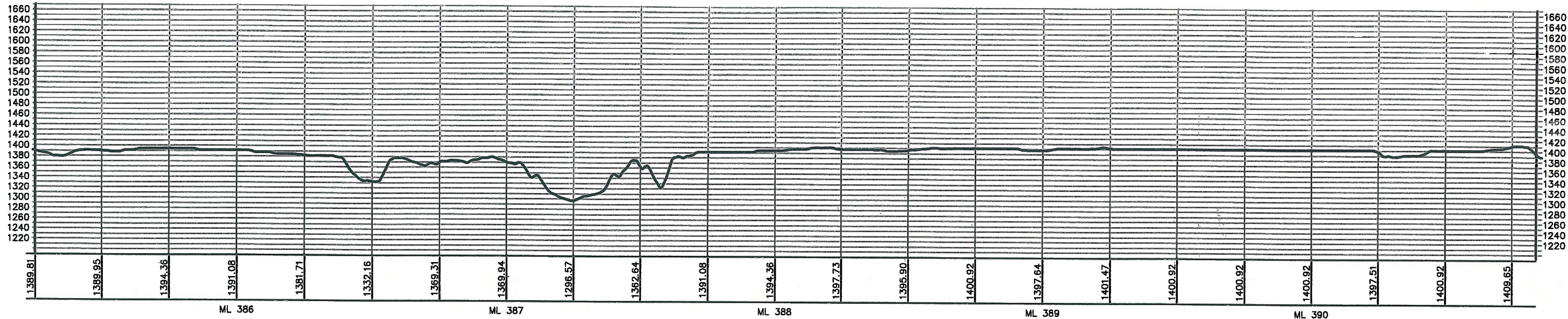

PREPARED BY: TROW ENGINEERING CONSULTANTS, INC. 1300 Metropolitan Boulevard, Suite 200 Tallahassee, Florida 32308 Phone: 1-850-385-5441 Fax: 1-850-385-5523			 Trow		 TransCanada <i>in business to deliver</i>							
<table border="1" style="width: 100%; border-collapse: collapse;"> <thead> <tr> <th style="width: 10%;">NO.</th> <th style="width: 60%;">REVISION</th> <th style="width: 30%;">DATE</th> </tr> </thead> <tbody> <tr> <td> </td> <td> </td> <td> </td> </tr> </tbody> </table>			NO.	REVISION	DATE				KEYSTONE PIPELINE PROJECT PROPOSED ROUTE BOOK		MAP PARAMETERS PROJECTION: NAD83, UTM: 14N SCALE: 1:24000, 1" = 2,000'	
NO.	REVISION	DATE										
ISSUED FOR DEPARTMENT OF STATE FILING MAR-13-06			PROJECT: 50388E		0070							
DRAWING NUMBER: K-46-P-900-A-0031		DRAWN BY: BEK		CHECKED BY: BLS		APPROVED BY: RG						
LAST PLOT DATE: Sun, 19 Mar 2006 - 4:04pm												

X:\Drawings\50388E\KEYSTONE\DRAWING FILES\DRAWINGS\24K MAP BOOKS\MAR 2006 ISSUE\02-PROFILES\REVISED UTM 14N SOUTH DAKOTA\K-46-P-900-A-0031-008-REV2.dwg 3/7/2006 11:38:07 PM EST

ELEVATIONS SHOWN IN FEET - VERTICAL = 10x HORIZONTAL SCALE

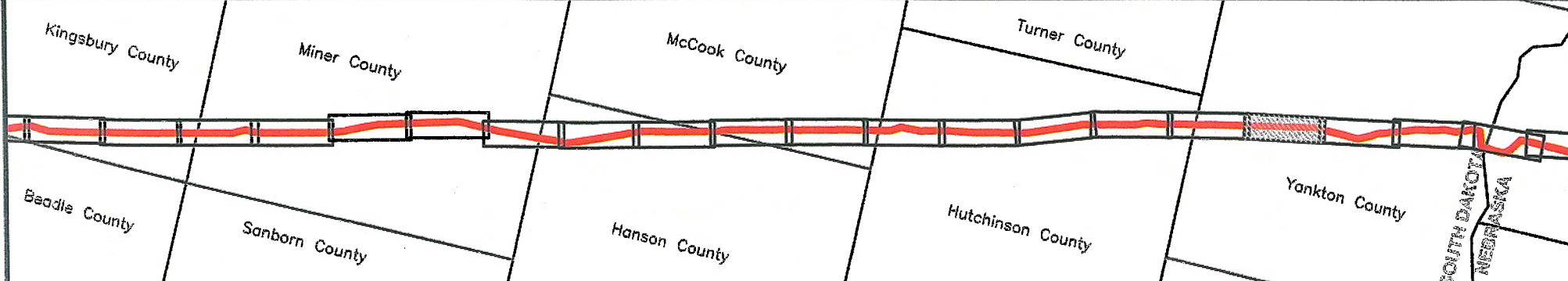
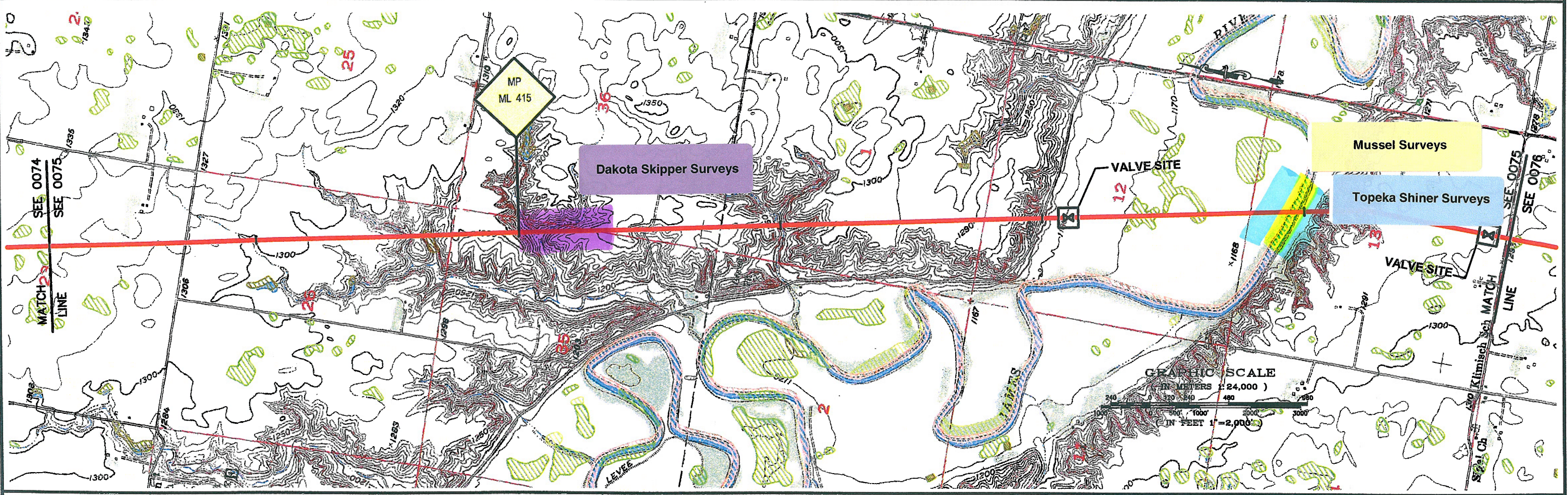
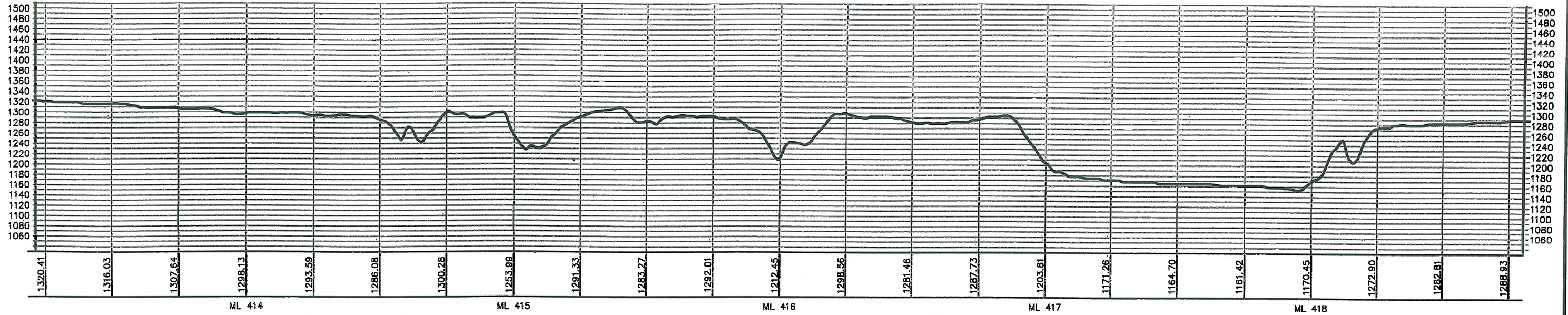

PREPARED BY:
TROW ENGINEERING CONSULTANTS, INC.
 1300 Metropolitan Boulevard, Suite 200
 Tallahassee, Florida 32308
 Phone: 1-850-385-5441
 Fax: 1-850-385-5523

NO.	REVISION	DATE

ISSUED FOR DEPARTMENT OF STATE FILING MAR.13.06

DRAWING NUMBER	DRAWN BY	CHECKED BY	APPROVED BY
K-46-P-900-A-0036	BEK	BLS	RG

TransCanada
in business to deliver

**KEYSTONE PIPELINE PROJECT
 PROPOSED ROUTE BOOK**

MAP PARAMETERS
 PROJECTION: NAD83, UTM: 14N
 SCALE: 1:24,000; 1" = 2,000'

PROJECT:	SHEET:
50388E	0075

LAST PLOT DATE:
 Sun, 19 Mar 2006 - 7:46pm

X:\Drawings\GIS\BBA KEYSTONE\DRAWING FILES\DRAWINGS\K46 MAP BOOK\MAR 2006 ISSUE\02-PROFILES\RENSED UTM 14\SD\DR\DAKOTAK-46-P-900-A-075-REV2.dwg 3/8/2006 9:22:31 AM EST

ELEVATIONS SHOWN IN FEET - VERTICAL = 10x HORIZONTAL SCALE

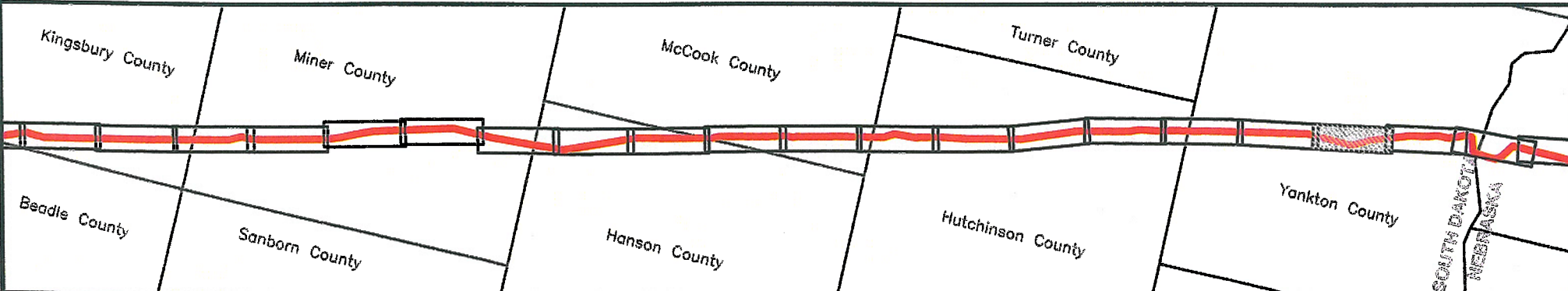
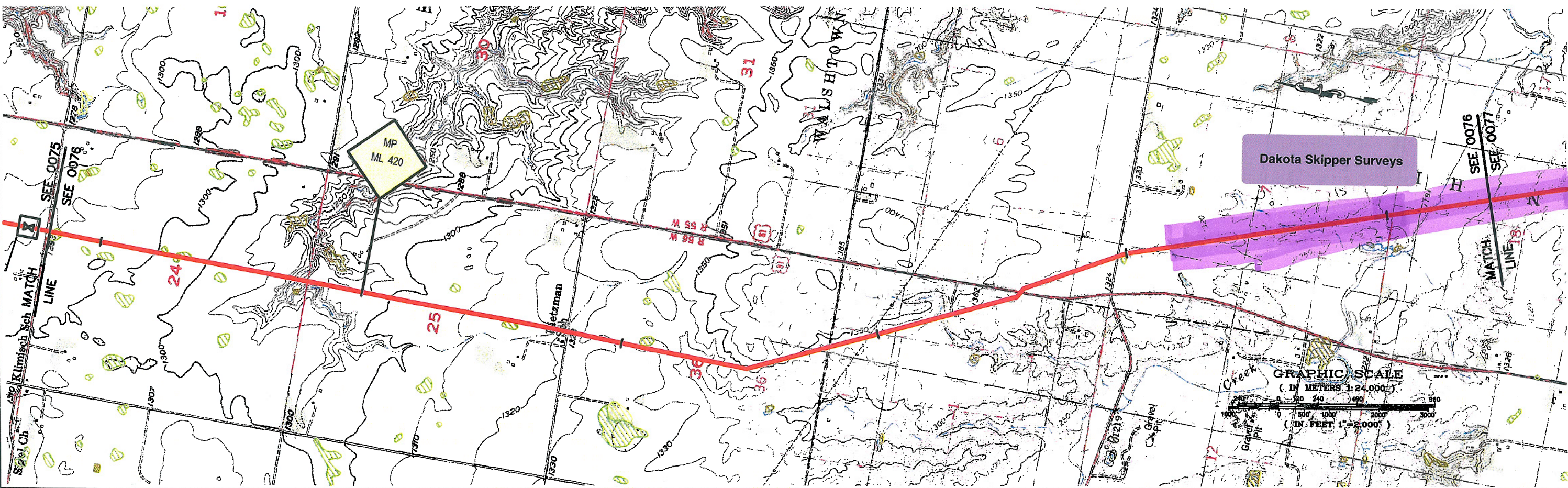
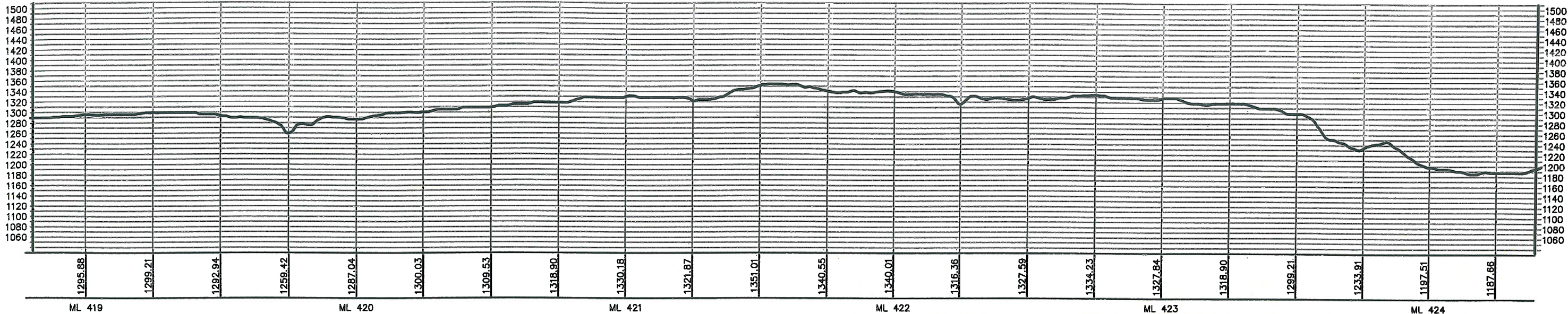

PREPARED BY:
TROW ENGINEERING CONSULTANTS, INC.
 1300 Metropolitan Boulevard, Suite 200
 Tallahassee, Florida 32308
 Phone: 1-850-385-5441
 Fax: 1-850-385-5523

TransCanada
in business to deliver

Trow

**KEYSTONE PIPELINE PROJECT
 PROPOSED ROUTE BOOK**

MAP PARAMETERS
 PROJECTION: NAD83, UTM: 14N
 SCALE: 1:24,000; 1" = 2,000'

NO.	REVISION	DATE

ISSUED FOR DEPARTMENT OF STATE FILING		MAR.13.06
DRAWING NUMBER	DRAWN BY	CHECKED BY
K-46-P-900-A-0037	BEK	BLS

PROJECT:	50388E	SHEET:	0076
APPROVED BY	RG	LAST PLOT DATE:	Sun, 19 Mar 2006 - 4:25pm

X:\Drawings\60388A KEYSTONE\DRAWING FILES\DRAWINGS\24K MAP BOOK\MAR 2006 ISSUE\02 - PROFILES\REVISED UTM 14 SOUTH DAKOTA K-46-P-900-A-072-REV2.dwg 3/9/2006 9:22:31 AM EST

ELEVATIONS SHOWN IN FEET - VERTICAL = 10x HORIZONTAL SCALE

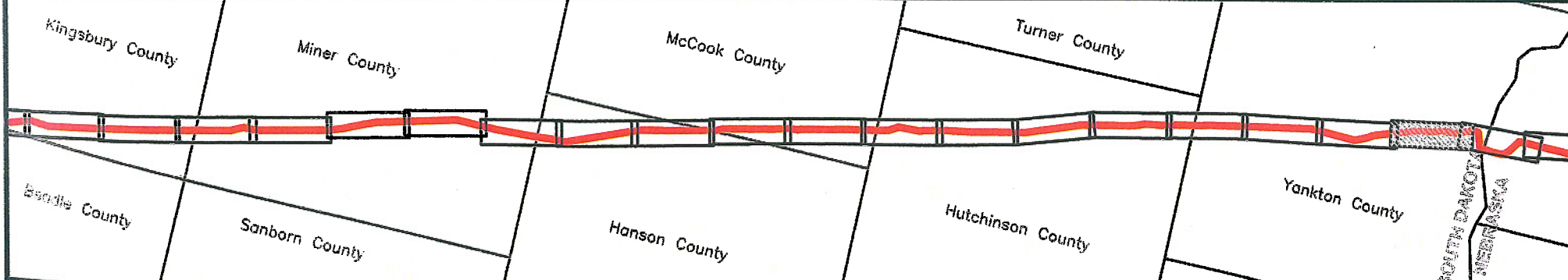
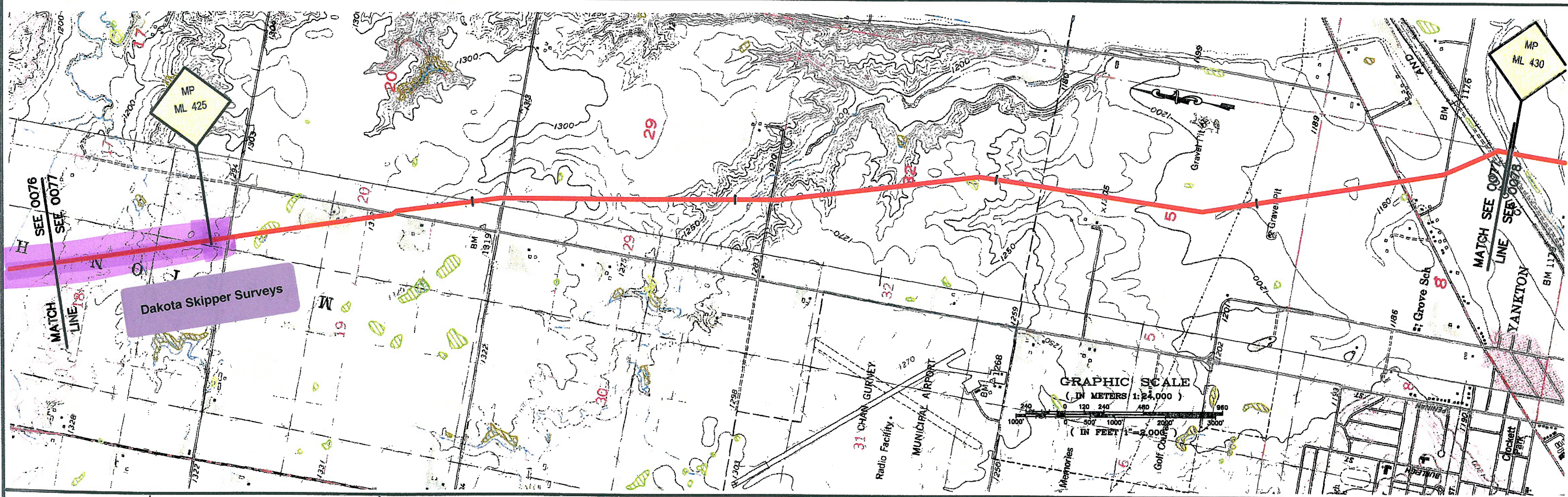
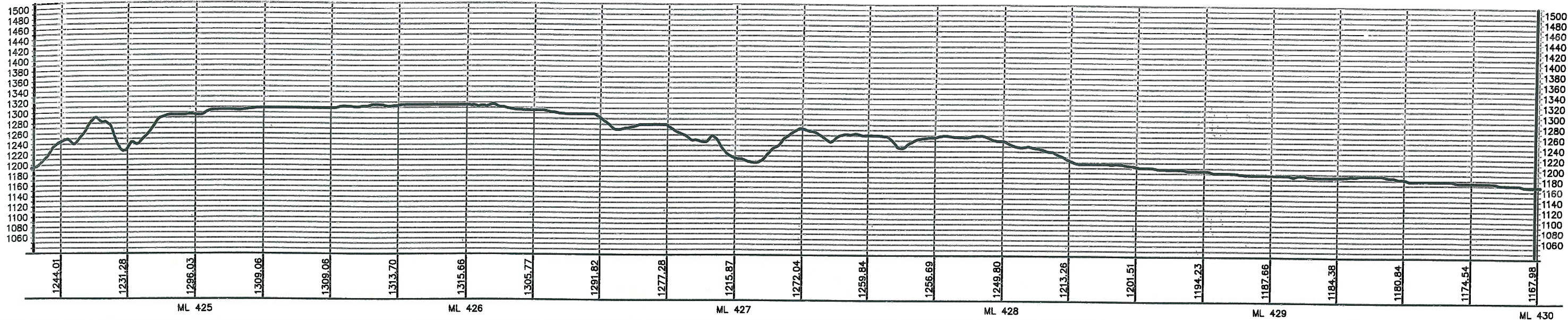

PREPARED BY:
TROW ENGINEERING CONSULTANTS, INC.
 1300 Metropolitan Boulevard, Suite 200
 Tallahassee, Florida 32308
 Phone: 1-850-385-5441
 Fax: 1-850-385-5523

TransCanada
in business to deliver

**KEYSTONE PIPELINE PROJECT
 PROPOSED ROUTE BOOK**

MAP PARAMETERS
 PROJECTION: NAD83, UTM: 14N
 SCALE: 1:24,000; 1" = 2,000'

NO.	REVISION	DATE
0	ISSUED FOR DEPARTMENT OF STATE FILING	MAR.13.06

DRAWING NUMBER	DRAWN BY	CHECKED BY	APPROVED BY
K-46-P-900-A-0038	BEK	BLS	RG

PROJECT: 50388E SHEET: 0077
 LAST PLOT DATE: Sun, 19 Mar 2006 - 4:19pm

X:\Drawing\A\020818\A\SYSTEM\DRAWING\FILES\DRAWINGS\244.MP BORDEN\MAR 2006 ISSUED FOR DEPARTMENT OF STATE FILING\14\STATE DAKOTA\K-46-P-900-A-0038-002-0002.dwg 3/19/2006 8:22:31 AM EST